

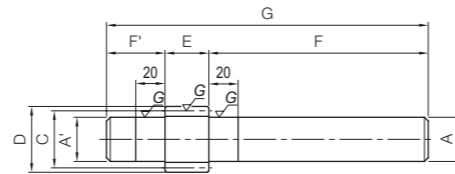

Specifications	
Precision grade	JIS grade N7 (JIS B1702-1:1998)*
Gear teeth	Standard full depth
Pressure angle	20°
Material	S45C
Heat treatment	Thermal refined, gear teeth induction hardened
Tooth hardness	50 to 60HRC
Surface treatment	Black oxide coated except for ground part



S7

Catalog Number	Pitch mm (Module)	No. of teeth	Profile shift coefficient	Shape	Shaft diameter (L)		Pitch dia.	Outside dia.	Face width	Shaft diameter (R)		Shaft length (R)
					A'	F'				A	F	
SSCPGS5-15	CP5 (1.5915)	15	0	S7	19.2		23.87	27.06	15	19.2		100
SSCPGS5-20		20	0		27.2	25	31.83	35.01		27.2		
SSCPGS5-25		25	0		30.2		39.79	42.97		30.2		
SSCPGS10-10	CP10 (3.1831)	10	+0.5	S7	25.2		31.83	41.38	30	25.2		150
SSCPGS10-15		15	0		35.2	40	47.75	54.11		35.2		
SSCPGS10-20		20	0		40.2		63.66	70.03		40.2		

Recommended mating rack



SRGCP

Please see Page 284 for more details.

Total Length G	Distance traveled in one turn (mm)	Allowable torque (N-m)		Allowable torque (kgf-m)		Backlash (mm)	Weight (kg)	Catalog Number
		Bending strength	Surface durability	Bending strength	Surface durability			
140	75	21.2	8.49	2.16	0.87	0.04~0.19	0.34	SSCPGS5-15 SSCPGS5-20 SSCPGS5-25
	100	32.0	16.6	3.26	1.70			
	125	43.2	27.8	4.40	2.83			
220	100	121	25.9	12.4	2.64	0.05~0.21	0.97	SSCPGS10-10 SSCPGS10-15 SSCPGS10-20
	150	169	67.9	17.3	6.93			
	200	256	133	26.1	13.6			



Specifications	
Precision grade	JIS grade N7 (JIS B 1702-1:1998)*
Gear teeth	Standard full depth
Pressure angle	20°
Material	S45C
Heat treatment	Gear teeth induction hardened
Tooth hardness	50 to 60HRC
Surface treatment	Black oxide coated except for teeth

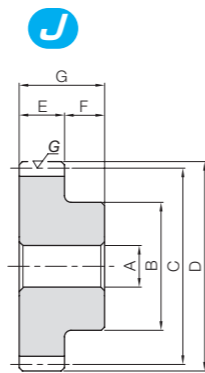

S1

\* The precision grade of J Series products is equivalent to the value shown in the table.

Catalog Number	Pitch mm (Module)	No. of teeth	Shape	Bore		Pitch dia.	Outside dia.	Face width	Hub width	Total length	Distance traveled in one turn (mm)	Allowable torque (N-m)				Backlash (mm)	Weight (kg)	
				A <sub>H7</sub>	B							Bending strength	Surface durability	Bending strength	Surface durability			
SSCPG5-20	CP5 (1.5915)	20	S1	8	25	31.83	35.01	15	15	30	100	24.8	13.7	2.53	1.40	0.04~0.19	0.14	
SSCPG5-25		25		10	32	39.79	42.97					33.5	23.0	3.41	2.34			
SSCPG5-30		30		10	38	47.75	50.93					42.3	35.0	4.32	3.57			
SSCPG5-40		40		12	50	63.66	66.85					60.4	66.9	6.16	6.82			
SSCPG10-20	CP10 (3.1831)	20	S1	15	50	63.66	70.03	30	20	50	200	198	110	20.2	11.2	0.05~0.21	0.99	
SSCPG10-25		25		20	60	79.58	85.94					250	268	184	27.3			18.7
SSCPG10-30		30		20	75	95.49	101.86					339	280	34.5	28.5			
SSCPG10-40		40		25	80	127.32	133.69					400	483	53.5	54.6			
SSCPG15-20	CP15 (4.7746)	20	S1	25	75	95.49	105.04	50	27	77	300	744	399	75.9	40.7	0.05~0.22	3.45	
SSCPG15-25		25		25	100	119.37	128.92					375	1005	667	102			68.0
SSCPG15-30		30		25	110	143.24	152.79					450	1270	1020	130			104
SSCPG20-20	CP20 (6.3662)	20	S1	25	100	127.32	140.06	60	30	90	400	1590	880	162	89.7	0.05~0.22	7.50	
SSCPG20-25		25		30	130	159.15	171.89					500	2140	1470	219			150
SSCPG20-30		30		30	150	190.99	203.72					600	2710	2240	276			228

Recommended mating rack



SRGCP

Please see Page 284 for more details.

J Series

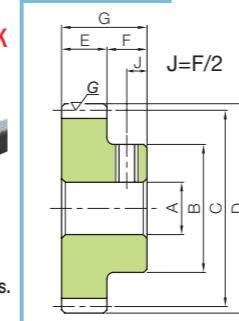

S1T

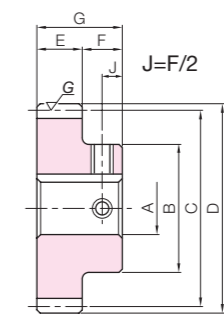

S1K



To order J Series products, please specify: **Catalog No. + J + BORE.**

Bore H7	* The product shapes of J Series items are identified by background color.																															
	8	10	12	14	15	16	17	18	19	20	22	25	28	30	32	35	40	45	50	55	60	65	70	75	80							
Keyway J <sub>S9</sub>	-																															
Screw size	4x1.8				5x2.3				6x2.8				8x3.3				10x3.3				12x3.3		14x3.8		16x4.3		18x4.4		20x4.9		22x5.4	
Catalog Number	M5				M4				M5				M6				M8				M10		M12		M16							
SSCPG5-20 J BORE	S1T	S1K	S1K																													
SSCPG5-25 J BORE		S1K	S1K	S1K	S1K	S1K	S1K																									
SSCPG5-30 J BORE			S1K	S1K	S1K	S1K	S1K	S1K	S1K	S1K	S1K																					
SSCPG5-40 J BORE				S1K	S1K	S1K	S1K	S1K	S1K	S1K	S1K	S1K	S1K	S1K																		
SSCPG10-20 J BORE							S1K	S1K	S1K	S1K	S1K	S1K	S1K	S1K	S1K	S1K																
SSCPG10-25 J BORE												S1K	S1K	S1K	S1K	S1K	S1K	S1K														
SSCPG10-30 J BORE													S1K	S1K	S1K	S1K	S1K	S1K	S1K	S1K												
SSCPG10-40 J BORE														S1K	S1K	S1K	S1K	S1K	S1K	S1K	S1K											
SSCPG15-20 J BORE																	S1K	S1K	S1K	S1K	S1K	S1K										
SSCPG15-25 J BORE																		S1K	S1K	S1K	S1K	S1K	S1K	S1K								
SSCPG15-30 J BORE																			S1K	S1K	S1K	S1K	S1K	S1K	S1K	S1K						
SSCPG20-20 J BORE																				S1K	S1K	S1K	S1K	S1K	S1K	S1K	S1K	S1K				
SSCPG20-25 J BORE																					S1K	S1K	S1K	S1K	S1K	S1K	S1K	S1K	S1K	S1K		
SSCPG20-30 J BORE																						S1K	S1K	S1K	S1K	S1K	S1K	S1K	S1K	S1K	S1K	