

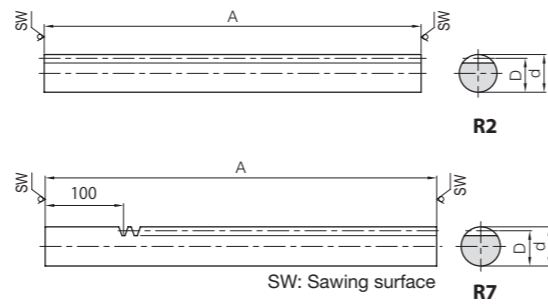

Specifications	
Precision grade	KHK R 001 grade 4
Gear teeth	Standard full depth
Pressure angle	20°
Material	S45C
Heat treatment	—
Tooth hardness	(less than 210HB)
Surface treatment	Black oxide coating



Catalog Number	Module	Effective number of teeth	Shape	Total Length			Allowable force (N)				Backlash (mm)	Weight (kg)
				A	Outside dia. d <sub>h9</sub>	Height to pitch line D	Bending strength	Surface durability	Bending strength	Surface durability		
<b>SRO1-500</b>	<b>m1</b>	159	R2	505	10	9	800	121	81.6	12.3	0.04~0.21	0.29
<b>SRO1.5-500</b>	<b>m1.5</b>	105		505	15	13.5	1800	288	184	29.3	0.09~0.25	0.65
<b>SRO2-500</b>	<b>m2</b>	79		505	20	18	3200	530	326	54.0	0.11~0.28	1.16
<b>SRO2-1000</b>		159		1010	20	18	3200	530	326	54.0	0.11~0.28	2.31
<b>SRO2.5-500</b>	<b>m2.5</b>	63		505	25	22.5	5000	848	510	86.5	0.13~0.31	1.81
<b>SRO2.5-1000</b>		127		1010	25	22.5	5000	848	510	86.5	0.13~0.31	3.61
<b>SRO3-500</b>	<b>m3</b>	52		505	30	27	7200	1240	735	127	0.14~0.35	2.60
<b>SRO3-1000</b>		105		1010	30	27	7200	1240	735	127	0.14~0.35	5.20
<b>SRO4-500</b>	<b>m4</b>	39		505	40	36	12800	2270	1310	232	0.18~0.42	4.62
<b>SRO4-1000</b>		79		1010	40	36	12800	2270	1310	232	0.18~0.42	9.24
<b>SRO5-1000</b>	<b>m5</b>	63	1010	50	45	20000	3620	2040	369	0.20~0.47	14.4	

Catalog Number	Module	Effective number of teeth	Shape	Total Length			Allowable force (N)				Backlash (mm)	Weight (kg)
				A	Outside dia. d <sub>h9</sub>	Height to pitch line D	Bending strength	Surface durability	Bending strength	Surface durability		
<b>SROS1-500</b>	<b>m1</b>	128	R7	505	10	9	800	121	81.6	12.3	0.04~0.21	0.29
<b>SROS1.5-500</b>	<b>m1.5</b>	85			15	13.5	1800	288	184	29.3	0.09~0.25	0.66
<b>SROS2-500</b>	<b>m2</b>	64			20	18	3200	530	326	54.0	0.11~0.28	1.17
<b>SROS2.5-500</b>	<b>m2.5</b>	51			25	22.5	5000	848	510	86.5	0.13~0.31	1.83
<b>SROS3-500</b>	<b>m3</b>	42			30	27	7200	1240	735	127	0.14~0.35	2.64

[Caution on Product Characteristics] ① Because this is extruded material, the outer diameter may be out of H9 tolerance in sections.  
 [Caution on Secondary Operations] ① Avoid hardening round racks, due to twisting and deformation occurring and the difficulty of straightening the rack after hardening.

**Recommended Mating Pinions**



**SS Spur Gears**

Please see Page 108 for more details.



Specifications	
Precision grade	KHK R 001 grade 5
Gear teeth	Standard full depth
Pressure angle	20°
Material	SUS303
Heat treatment	—
Tooth hardness	(less than 187HB)

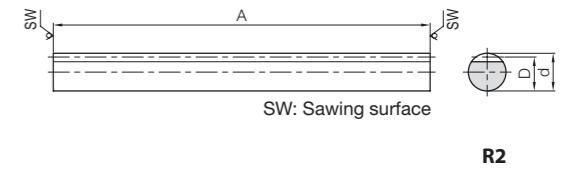

Catalog Number	Module	Effective number of teeth	Shape	Total Length			Allowable force (N)				Backlash (mm)	Weight (kg)
				A	Outside dia. d <sub>h9</sub>	Height to pitch line D	Bending strength	Surface durability	Bending strength	Surface durability		
<b>SURO1-500</b>	<b>m1</b>	159	R2	505	10	9	382	67.9	39.0	6.93	0.04~0.23	0.29
<b>SURO1.5-500</b>	<b>m1.5</b>	105		505	15	13.5	859	162	87.6	16.5	0.09~0.27	0.66
<b>SURO2-500</b>	<b>m2</b>	79		505	20	18	1530	298	156	30.4	0.11~0.30	1.17
<b>SURO2-1000</b>		159		1010	20	18	1530	298	156	30.4	0.11~0.30	2.33
<b>SURO2.5-500</b>	<b>m2.5</b>	63		505	25	22.5	2390	477	243	48.7	0.13~0.33	1.82
<b>SURO2.5-1000</b>		127		1010	25	22.5	2390	477	243	48.7	0.13~0.33	3.65
<b>SURO3-500</b>	<b>m3</b>	52		505	30	27	3440	700	351	71.4	0.14~0.37	2.63
<b>SURO3-1000</b>		105		1010	30	27	3440	700	351	71.4	0.14~0.37	5.25

[Caution on Product Characteristics] ① Because this is extruded material, the outer diameter may be out of H9 tolerance in sections.

**Recommended Mating Pinions**

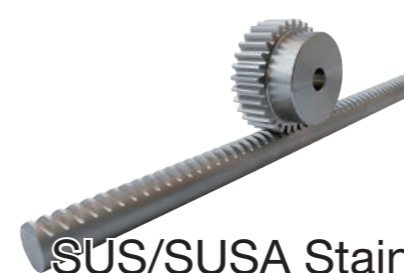

**SUS/SUSA Stainless Steel Spur Gears**

Please see Page 156 for more details.