

Specifications	
Precision grade	KHK R 001 grade 5
Gear teeth	Standard full depth
Pressure angle	20°
Material	S45C
Heat treatment	Gear teeth induction hardened
Tooth hardness	50 to 60HRC
Surface treatment	Black oxide coating

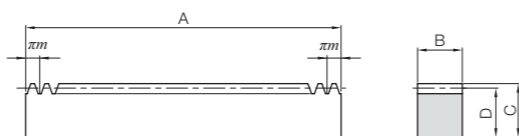

RF

J Series

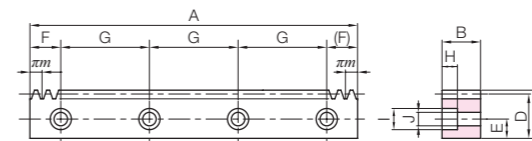

RD



Catalog Number	Module	No. of teeth	Shape	Total Length	Face width	Height	Height to pitch line	Allowable force (N)		Allowable force (kgf)	
				A	B	C	D	Bending strength	Surface durability	Bending strength	Surface durability
SRF1.5-1000H	m1.5	212	RF	999.03	15	20	18.5	1960	1110	200	113
SRF2-1000H	m2	160		1005.31	20	25	23	3480	2000	355	204
SRF2.5-1000H	m2.5	128		1005.31	25	30	27.5	5440	3160	555	322
SRF3-1000H	m3	106		999.03	30	35	32	7840	4590	799	468
SRF4-1000H	m4	80		1005.31	40	45	41	13900	8310	1420	847
SRF5-1000H	m5	64		1005.31	50	50	45	21800	13200	2220	1340
SRF6-1000H	m6	53	999.03	60	60	54	31400	19200	3200	1960	

Backlash (mm)	Weight (kg)	Catalog Number
0.05~0.29	2.18	SRF1.5-1000H
0.07~0.32	3.63	SRF2-1000H
0.09~0.35	5.43	SRF2.5-1000H
0.10~0.39	7.53	SRF3-1000H
0.14~0.46	12.9	SRF4-1000H
0.16~0.51	17.8	SRF5-1000H
0.18~0.58	25.4	SRF6-1000H

Catalog Number	Module	No. of teeth	Shape	Total Length	Face width	Height	Height to pitch line	Mounting hole dimensions				
				A	B	C	D	E	F	G	No. of holes	Screw size
● SRFD1.5-1000HJ	m1.5	212	RD	999.03	15	20	18.5	8	49.51	180	6	M5
● SRFD2-1000HJ	m2	160		1005.31	20	25	23	10	52.65	180	6	M6
● SRFD2.5-1000HJ	m2.5	128		1005.31	25	30	27.5	12	52.65	180	6	M8
● SRFD3-1000HJ	m3	106		999.03	30	35	32	14	49.51	180	6	M10
● SRFD4-1000HJ	m4	80		1005.31	40	45	41	18	52.65	180	6	M12
● SRFD5-1000HJ	m5	64		1005.31	50	50	45	20	62.65	220	5	M14
● SRFD6-1000HJ	m6	53	999.03	60	60	54	23	59.51	220	5	M16	

Counterbore dimensions			Allowable force (N)		Allowable force (kgf)		Backlash (mm)	Weight (kg)	Catalog Number
H	I	J	Bending strength	Surface durability	Bending strength	Surface durability			
6	10	6	1960	1110	200	113	0.05~0.29	2.14	● SRFD1.5-1000HJ
7	11	7	3480	2000	355	204	0.07~0.32	3.58	● SRFD2-1000HJ
8.6	14	9	5440	3160	555	322	0.09~0.35	5.31	● SRFD2.5-1000HJ
10.8	17.5	11	7840	4590	799	468	0.10~0.39	7.32	● SRFD3-1000HJ
13	20	14	13900	8310	1420	847	0.14~0.46	12.6	● SRFD4-1000HJ
15.2	23	16	21800	13200	2220	1340	0.16~0.51	17.2	● SRFD5-1000HJ
17.5	26	18	31400	19200	3200	1960	0.18~0.58	24.6	● SRFD6-1000HJ

Recommended Mating Pinions



SS- Hardened Spur Gears

Please see Page 106 for more details.

