

Specifications	
Precision grade	KHK R 001 Grade 4*
Gear teeth	Standard full depth
Pressure angle	20°
Material	S45C
Heat treatment	Gear teeth laser hardened
Tooth hardness	55 to 65HRC
Surface treatment	Black oxide coating

\* The precision grade of these products is equivalent to the value shown in the table.

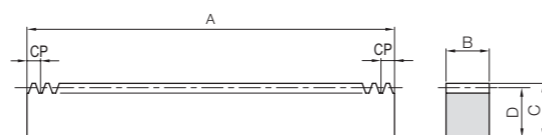

RF

J Series

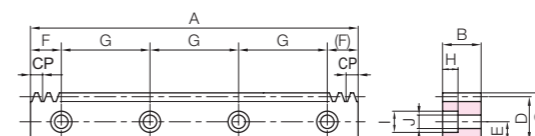

RD



Catalog Number	Pitch mm (Module)	No. of teeth	Shape	Total Length				Allowable force (N)		Allowable force (kgf)	
				A	B	C	D	Bending strength	Surface durability	Bending strength	Surface durability
SRCPF5-1000HL	CP5 (1.5915)	200	RF	1000	15	20	18.41	2290	1040	232	106
SRCPF5-1500HL		300									
SRCPF5-2000HL		410									
SRCPF10-1000HL	CP10 (3.1831)	100		1000	30	35	31.82	9150	4330	933	441
SRCPF10-1500HL		150									
SRCPF10-2000HL		205									
SRCPF15-1000HL	CP15 (4.7746)	67		1005	50	50	45.23	22900	10700	2333	1095
SRCPF15-1500HL		100									
SRCPF15-2000HL		136									
SRCPF20-1000HL	CP20 (6.3662)	50		1000	60	60	53.63	36600	18100	3732	1843
SRCPF20-1500HL		75									
SRCPF20-2000HL		102									

Backlash (mm)	Weight (kg)	Catalog Number	
		0.09~0.25	2.17
0.14~0.35	3.25	SRCPF5-2000HL	
	4.44		
	7.49	SRCPF10-1000HL	SRCPF10-1500HL
0.20~0.47	11.2	SRCPF10-2000HL	
	15.4		
	17.8	SRCPF15-1000HL	SRCPF15-1500HL
0.22~0.54	26.6	SRCPF15-2000HL	
	36.2		
	25.3	SRCPF20-1000HL	SRCPF20-1500HL
	37.9	SRCPF20-2000HL	
	51.5		

Catalog Number	Pitch mm (Module)	No. of teeth	Shape	Total Length				Mounting hole dimensions				
				A	B	C	D	E	F	G	No. of holes	Screw size
SRCPFD5-1000HLJ	CP5 (1.5915)	200	RD	1000	15	20	18.41	8	50	180	9	M5
SRCPFD5-1500HLJ		300										
SRCPFD5-2000HLJ		410										
SRCPFD10-1000HLJ	CP10 (3.1831)	100		1000	30	35	31.82	14	50	180	9	M10
SRCPFD10-1500HLJ		150										
SRCPFD10-2000HLJ		205										
SRCPFD15-1000HLJ	CP15 (4.7746)	67		1005	50	50	45.23	20	62.5	220	7	M14
SRCPFD15-1500HLJ		100										
SRCPFD15-2000HLJ		136										
SRCPFD20-1000HLJ	CP20 (6.3662)	50		1000	60	60	53.63	23	60	220	7	M16
SRCPFD20-1500HLJ		75										
SRCPFD20-2000HLJ		102										

Counterbore dimensions			Allowable force (N)		Allowable force (kgf)		Backlash (mm)	Weight (kg)	Catalog Number
H	I	J	Bending strength	Surface durability	Bending strength	Surface durability			
6	10	6	2290	1040	232	106	0.09~0.25	2.13	SRCPFD5-1000HLJ
10.8	17.5	11	9150	4330	933	441	0.14~0.35	3.20	SRCPFD5-1500HLJ
								4.38	SRCPFD5-2000HLJ
								7.29	SRCPFD10-1000HLJ
15.2	23	16	22900	10700	2333	1095	0.20~0.47	10.9	SRCPFD10-1500HLJ
								14.9	SRCPFD10-2000HLJ
								17.3	SRCPFD15-1000HLJ
17.5	26	18	36600	18100	3732	1843	0.22~0.54	25.9	SRCPFD15-1500HLJ
								35.2	SRCPFD15-2000HLJ
								24.5	SRCPFD20-1000HLJ
								36.8	SRCPFD20-1500HLJ
								50.0	SRCPFD20-2000HLJ

\* CP30 and ground racks with total lengths up to (A) 1500mm and heights up to (C) 120mm are also available by request as custom-made products.

Recommended Mating Pinions

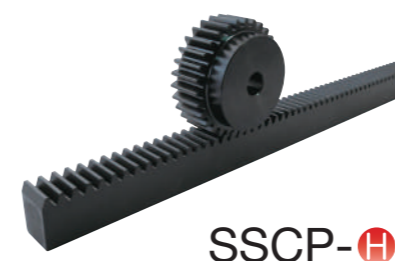

Please see Page 290 for more details.