

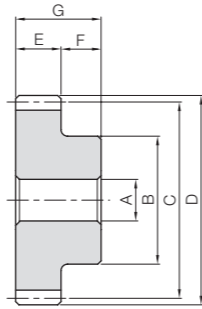

Specifications	
Precision grade	JIS grade N9 (JIS B1702-1:1998)*
Reference section of gear	Normal plane
Gear teeth	Standard full depth
Normal pressure angle	20°
Helix angle	45°
Material	S45C
Heat treatment	—
Surface treatment	Black oxide coating

* The precision grade of J Series products is equivalent to the value shown in the table.



S1

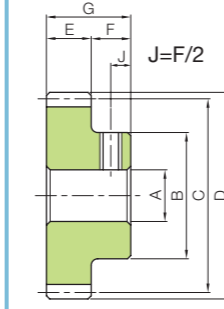

S1T

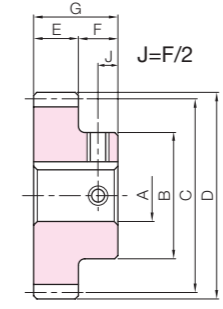

S1K



To order Hardened Plus, please specify **Catalog No. + H**. Example: **SN1-13RH**

Catalog Number	Module	No. of teeth	Direction of helix	Shape	Bore	Hub dia.	Pitch dia.	Outside dia.	Face width	Hub width	Total length	Allowable torque				Backlash (mm)	Weight (kg)									
												Surface durability		Surface durability H												
A _{H7}	B	C	D	E	F	G	N·m	kgf·m	N·m	kgf·m																
SN1-13R SN1-13L	m1	13	R	S1	6	15	18.38	20.38	10	10	20	0.19	0.019	0.41	0.04	0.08~0.18	0.030									
SN1-15R SN1-15L			L				21.21	23.21				0.29	0.029	0.62	0.06											
SN1-20R SN1-20L		20	R				28.28	30.28				0.66	0.068	1.44	0.15											
SN1-26R SN1-26L			L				36.77	38.77				1.42	0.14	3.08	0.31											
SN1-30R SN1-30L		30	R				35	42.43				44.43	2.14	0.22	4.64			0.47								
SN1-5-10R SN1-5-10L			m1.5					10				R	S1	8	16			21.21	24.21	15	10	25	0.29	0.029	0.62	0.06
SN1-5-13R SN1-5-13L		L					23					27.58			30.58			0.62	0.063				1.34	0.14		
SN1-5-15R SN1-5-15L	15	R		25	31.82	34.82	0.93	0.095	2.03	0.21																
SN1-5-20R SN1-5-20L		L		30	42.43	45.43	2.14	0.22	4.64	0.47																
SN1-5-26R SN1-5-26L	26	R		40	55.15	58.15	4.51	0.46	9.80	1.00																
SN1-5-30R SN1-5-30L		L			45	63.64	66.64	6.75	0.69	14.7	1.50															
SN2-10R SN2-10L	m2	10		R	S1	12	22	28.28	32.28	20	15	35			0.66	0.068	1.44	0.15	0.12~0.26				0.11			
SN2-13R SN2-13L				L			30	36.77	40.77						1.42	0.14	3.08	0.31								
SN2-15R SN2-15L		15		R			35	42.43	46.43						2.14	0.22	4.64	0.47								
SN2-20R SN2-20L				L			45	56.57	60.57						4.84	0.49	10.5	1.07								
SN2-26R SN2-26L		26	R	60			73.54	77.54	10.1				1.03	22.0	2.24											
SN2-30R SN2-30L			L				65	84.85	88.85				15.0	1.53	32.7	3.34										

To order J Series products, please specify: **Catalog No. + J + BORE**. Example: **SN1-13RJ**

Catalog Number	Bore H7		* The product shapes of J Series items are identified by background color.																
	6	8	10	12	14	15	16	17	18	19	20	22	25	28	30	32	35		
Keyway J _{s9}	—		4×1.8				5×2.3				6×2.8				8×3.3				10×3.3
Screw size	—		M4				M5				M6				M8				
SN1-13R J BORE	*S1T																		
SN1-13L J BORE	*S1T																		
SN1-15R J BORE	*S1T	*S1T																	
SN1-15L J BORE	*S1T	*S1T																	
SN1-20R J BORE		*S1T	*S1K	*S1K															
SN1-20L J BORE		*S1T	*S1K	*S1K															
SN1-26R J BORE			*S1K	*S1K	*S1K	*S1K	*S1K	*S1K											
SN1-26L J BORE			*S1K	*S1K	*S1K	*S1K	*S1K	*S1K											
SN1-30R J BORE			*S1K	*S1K	*S1K	*S1K	*S1K	*S1K	*S1K	*S1K									
SN1-30L J BORE			*S1K	*S1K	*S1K	*S1K	*S1K	*S1K	*S1K	*S1K	*S1K								
SN1.5-10R J BORE	*S1T																		
SN1.5-10L J BORE	*S1T																		
SN1.5-13R J BORE			*S1K																
SN1.5-13L J BORE			*S1K																
SN1.5-15R J BORE			*S1K	*S1K															
SN1.5-15L J BORE			*S1K	*S1K															
SN1.5-20R J BORE			*S1K	*S1K	*S1K	*S1K	*S1K	*S1K											
SN1.5-20L J BORE			*S1K	*S1K	*S1K	*S1K	*S1K	*S1K											
SN1.5-26R J BORE			*S1K	*S1K	*S1K	*S1K	*S1K	*S1K	*S1K	*S1K									
SN1.5-26L J BORE			*S1K	*S1K	*S1K	*S1K	*S1K	*S1K	*S1K	*S1K	*S1K								
SN1.5-30R J BORE			*S1K	*S1K	*S1K	*S1K	*S1K	*S1K	*S1K	*S1K	*S1K	*S1K							
SN1.5-30L J BORE			*S1K	*S1K	*S1K	*S1K	*S1K	*S1K	*S1K	*S1K	*S1K	*S1K	*S1K						
SN2-10R J BORE			*S1K																
SN2-10L J BORE			*S1K																
SN2-13R J BORE			*S1K	*S1K	*S1K	*S1K	*S1K												
SN2-13L J BORE			*S1K	*S1K	*S1K	*S1K	*S1K												
SN2-15R J BORE			*S1K	*S1K	*S1K	*S1K	*S1K	*S1K	*S1K										
SN2-15L J BORE			*S1K	*S1K	*S1K	*S1K	*S1K	*S1K	*S1K	*S1K									
SN2-20R J BORE					*S1K	*S1K	*S1K	*S1K	*S1K	*S1K	*S1K								
SN2-20L J BORE					*S1K	*S1K	*S1K	*S1K	*S1K	*S1K	*S1K								
SN2-26R J BORE												*S1K	*S1K	*S1K	*S1K	*S1K	*S1K		
SN2-26L J BORE												*S1K	*S1K	*S1K	*S1K	*S1K	*S1K		
SN2-30R J BORE												*S1K	*S1K	*S1K	*S1K	*S1K	*S1K		
SN2-30L J BORE												*S1K	*S1K	*S1K	*S1K	*S1K	*S1K		

To order J Series Hardened Plus products, please specify: **Catalog No. + H + J + BORE**. Example: **SN1-15RHJ8**

*** is a product with the original bore diameter, so Hardened Plus is not available. See Page 22 for more details on Hardened Plus.



