

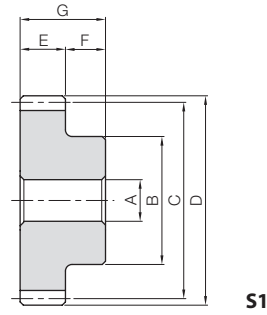

Specifications	
Precision grade	JIS grade N8 (JIS B1702-1: 1998)
Reference section of gear	Normal plane
Gear teeth	Standard full depth
Normal pressure angle	20°
Helix angle	15°
Material	S45C
Heat treatment	—
Tooth hardness	(less than 194HB)
Surface treatment	Black oxide coating



Catalog Number	Module	No. of teeth	Direction of helix	Shape	Bore	Hub dia.	Pitch dia.	Outside dia.	Face width	Hub width	Total length
					A _{H7}	B	C	D	E	F	G
SH2-15R SH2-15L	m2	15	R L	S1	12	24	31.06	35.06	25	10	35
SH2-20R SH2-20L		20	R L		12	32	41.41	45.41			
SH2-30R SH2-30L		30	R L		12	50	62.12	66.12			
SH2-40R SH2-40L		40	R L		18	60	82.82	86.82			
SH2-60R SH2-60L		60	R L		18	70	124.23	128.23			
SH2-90R SH2-90L		90	R L		18	120	186.35	190.35			
SH3-15R SH3-15L	m3	15	R L	S1	15	36	46.59	52.59	35	15	50
SH3-20R SH3-20L		20	R L		15	50	62.12	68.12			
SH3-30R SH3-30L		30	R L		20	70	93.17	99.17			
SH3-40R SH3-40L		40	R L		20	80	124.23	130.23			
SH3-60R SH3-60L		60	R L		20	140	186.35	192.35			

Allowable torque (N·m)		Allowable torque (kgf·m)		Backlash (mm)	Weight (kg)	Catalog Number
Bending strength	Surface durability	Bending strength	Surface durability			
43.7	2.90	4.46	0.30	0.12~0.26	0.15	SH2-15R SH2-15L
67.1	5.85	6.84	0.60		0.30	SH2-20R SH2-20L
117	15.3	11.9	1.56		0.72	SH2-30R SH2-30L
169	28.9	17.2	2.95		1.21	SH2-40R SH2-40L
275	70.8	28.0	7.22		2.61	SH2-60R SH2-60L
437	173	44.6	17.6		6.17	SH2-90R SH2-90L
138	9.67	14.0	0.99	0.14~0.32	0.52	SH3-15R SH3-15L
211	19.4	21.6	1.98		0.99	SH3-20R SH3-20L
368	50.2	37.5	5.12		2.20	SH3-30R SH3-30L
531	95.5	54.1	9.73		3.80	SH3-40R SH3-40L
866	236	88.3	24.0		9.18	SH3-60R SH3-60L

Reference Section of Gears

Transverse module (SH helical gears) and normal module (KHG ground helical gears) are available for the gear teeth according to the gear reference cross section. Even if products have the same helix angle and module, transverse and normal module gears have different gear teeth and thus cannot engage.

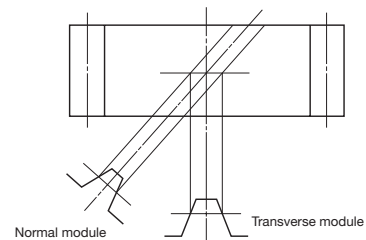

* Above is for illustration purposes only and differs from actual tooth forms.

Center Distance Table of SH Helical Gears

Catalog Number	SH2-15 ^R _L	SH2-20 ^R _L	SH2-30 ^R _L	SH2-40 ^R _L	SH2-60 ^R _L	SH2-90 ^R _L
SH2-15 ^R _L	31.06	—	—	—	—	—
SH2-20 ^R _L	36.23	41.41	—	—	—	—
SH2-30 ^R _L	46.59	51.76	62.12	—	—	—
SH2-40 ^R _L	56.94	62.12	72.47	82.82	—	—
SH2-60 ^R _L	77.65	82.82	93.17	103.53	124.23	—
SH2-90 ^R _L	108.70	113.88	124.23	134.59	155.29	186.35

Center Distance Table of SH Helical Gears

Catalog Number	SH3-15 ^R _L	SH3-20 ^R _L	SH3-30 ^R _L	SH3-40 ^R _L	SH3-60 ^R _L
SH3-15 ^R _L	46.59	—	—	—	—
SH3-20 ^R _L	54.35	62.12	—	—	—
SH3-30 ^R _L	69.88	77.65	93.17	—	—
SH3-40 ^R _L	85.41	93.17	108.70	124.23	—
SH3-60 ^R _L	116.47	124.23	139.76	155.29	186.35