

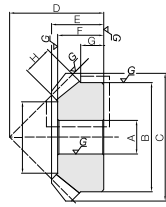

Specifications	
Precision grade	JIS B 1704: 1978 grade 0
Gear teeth	Gleason
Pressure angle	20°
Helix angle	35°
Material	SCM415
Heat treatment	Tooth area carburized
Tooth hardness	55 to 60HRC

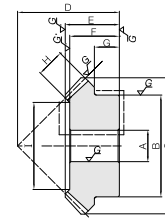

B3



B4

All machining datum planes are cut and locating the center is made easy to maintain accuracy KHK's highest-grade spiral miter with excellent quietness

Catalog Number	Gear Ratio	Module	No. of teeth	Direction of spiral	Pitch dia.	Shape	Bore	Hub dia.	Outside dia.	Mounting distance	Total length	Hole length	
							A _{H7}	B	C	D	E	F	
MMSGQ2-20R MMSGQ2-20L	1	m2	20	R	40	B3	12	35	40	35	21	20	
MMSGQ2.5-20R MMSGQ2.5-20L				R			14	42	51	45	28	26	
MMSGQ3-20R MMSGQ3-20L				L	16		52	61	50	30	27		
				R	20		50	71	55	31.5	29		
MMSGQ3.5-20R MMSGQ3.5-20L		L		20	55	81	65	38	35				
		R		20	55	81	65	38	35				
MMSGQ2-30R MMSGQ2-30L MMSGQ2.5-30R MMSGQ2.5-30L MMSGQ3-30R MMSGQ3-30L MMSGQ3.5-30R MMSGQ3.5-30L MMSGQ4-30R MMSGQ4-30L		m2		30	R	60	B4	14	45	60	50	28.5	26
					L			16	55	76	60	33	30
					R	20		65	91	70	39.5	36	
					L	25		80	106	80	43.5	40	
		MMSGQ3.5-30R MMSGQ3.5-30L			L	25	80	106	80	43.5	40		
					R	28	90	121	90	48	44		
	MMSGQ4-30R MMSGQ4-30L	L	28		90	121	90	48	44				
		R	28		90	121	90	48	44				

- [Caution on Product Characteristics] ① A set of miter gears must be identical in module and number of teeth, but opposite in spiral hands.
 ② The allowable torques shown in the table are calculated values according to the assumed usage conditions. Please see Page 302 for more details.
 ③ These gears produce axial thrust forces. Please see Page 304 for more details.

Hub width	Face width	Holding surface dia.	Allowable torque (N·m)		Allowable torque (kgf·m)		Backlash (mm)	Weight (kg)	Catalog Number
			Bending strength	Surface durability	Bending strength	Surface durability			
G	H	I							
12.5	9	24.54	17.0	23.5	1.73	2.40	0~0.05	0.14	MMSGQ2-20R MMSGQ2-20L
16	11	30.89	32.7	46.1	3.33	4.70	0.05~0.10	0.27	MMSGQ2.5-20R MMSGQ2.5-20L
16	14	34.4	58.5	83.7	5.97	8.54			
14	16	42.75	91.8	133	9.36	13.6			
17	18	49.08	136	199	13.8	20.3			
15	12	38.06	38.5	78.6	3.93	8.02	0~0.05	0.36	MMSGQ2-30R MMSGQ2-30L
16	15	47.57	75.3	156	7.68	16.0	0.05~0.10	0.66	MMSGQ2.5-30R MMSGQ2.5-30L
18	20	55.43	139	294	14.2	30.0			
20	22	67.77	204	436	20.8	44.5			
22	25	77.29	303	657	30.9	67.0			
								1.11	MMSGQ3-30R MMSGQ3-30L
								1.75	MMSGQ3.5-30R MMSGQ3.5-30L
								2.49	MMSGQ4-30R MMSGQ4-30L

- [Caution on Secondary Operations] ① Please read "Cautions on Performing Secondary Operations" (Page 304) when performing modifications and/or secondary operations for safety concerns.
 KHK Quick-Mod Gears, the KHK system for quick modification of KHK stock gears, is also available.
 ② In the illustration, the area surrounded with - - - line is masked during the carburization process and can be modified. However, note that high hardness (HRC40 at maximum) occurs in some cases.

JIS grade 0 Ground bevel gears
Custom Gears are also available.



CNC Bevel Gear Grinding Machine (PH-280HG)



Gear Measuring System (350GMS)

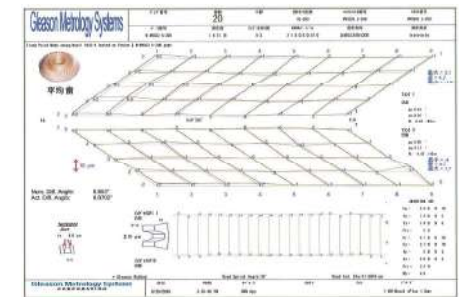

Gear Measurement Data