

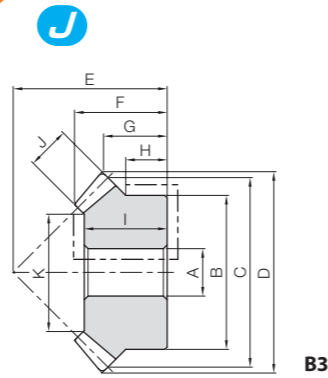

Specifications	
Precision grade	JIS B 1704: 1978 grade 4
Gear teeth	Gleason
Pressure angle	20°
Material	SCM415
Heat treatment	Tooth area carburized
Tooth hardness	55 to 60HRC
Surface treatment	Black oxide coating

* The precision grade of J Series products is equivalent to the value shown in the table.



B3

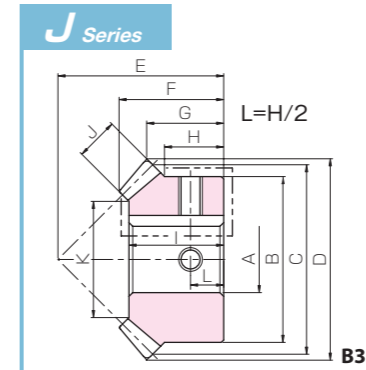

B3K



To order J Series products, please specify: **Catalog No. + J + BORE.**

Catalog Number	Gear Ratio	No. of teeth	Shape	Bore H7													Allowable torque (N·m)				Allowable torque (kgf·m)				Backlash (mm)	Weight (kg)				
				A _{H7}	B	C	D	E	F	G	H	I	J	K	L	M	N	O	P	Q	R	S	T							
MM2-20	1	20	B3	12	34	40	42.83	35	22.24	16.41	12	20	9	24.54	15.1	9.74	1.54	0.99	0.06~0.16	0.13										
MM2.5-20				15	42	50	53.54	45	28.89	21.77	16	26	11	30.89	29.0	19.0	2.96	1.94	0.07~0.17	0.27										
MM3-20				16	52	60	64.24	50	31.19	22.12	16	27	14	34.4	52.0	34.5	5.30	3.52	0.08~0.18	0.43										
MM4-20				20	65	80	85.66	65	39.49	27.83	17.5	35	18	49.09	121	81.2	12.3	8.28	0.12~0.27	0.93										
MM5-20				25	80	100	107.07	90	60.38	43.54	30	54	26	54.46	256	175	26.1	17.8	0.14~0.34	2.15										
MM2-25	1	25	B3	12	45	50	52.83	40	24.33	16.41	12.5	21	12	28.06	26.4	20.1	2.70	2.05	0.06~0.16	0.25										
MM2.5-25				16	55	62.5	66.03	50	30.41	20.52	15	27	15	36.57	51.6	39.7	5.27	4.05	0.07~0.17	0.47										
MM3-25				20	65	75	79.24	60	37.81	24.62	17.5	33	20	39.43	94.7	73.5	9.66	7.49	0.08~0.18	0.81										
MM4-25				25	85	100	105.66	80	49.32	32.83	22.5	44	25	57.29	217	171	22.1	17.4	0.12~0.27	1.89										
MM5-25				28	100	125	132.07	100	60.82	41.04	25	50	30	65.15	413	329	42.1	33.6	0.14~0.34	3.41										
MM2-30	1	30	B3	12	45	60	62.83	50	29.43	21.41	12.5	25	12	36.06	35.7	31.1	3.64	3.17	0.06~0.16	0.37										
MM2.5-30				16	60	75	78.54	62	36.28	26.27	17	32	15	47.57	69.7	61.5	7.11	6.27	0.07~0.17	0.76										
MM3-30				20	70	90	94.24	75	45.47	32.12	20	40	20	53.43	129	115	13.2	11.7	0.08~0.18	1.32										
MM4-30				28	100	120	125.66	95	54.52	37.83	25	50	25	79.29	293	266	29.9	27.1	0.12~0.27	3.09										
MM5-30				28	130	150	157.07	120	68.56	48.54	35	62	30	99.15	558	513	56.9	52.3	0.14~0.34	6.47										

Keyway J _{S9}	* The product shapes of J Series items are identified by background color.																											
	12	14	15	16	17	18	19	20	22	25	28	30	32	35	40	45	50	55	60	65	70	75	80	85				
Screw size	4x1.8	5x2.3				6x2.8				8x3.3				10x3.3				12x3.3	14x3.8	16x4.3	18x4.4	20x4.9	22x5.4					
Catalog Number	M4				M5				M6				M8				M10				M12				M16			
MM2-20 J BORE	B3K	B3K	B3K	B3K	B3K	B3K	B3K																					
MM2.5-20 J BORE			B3K	B3K	B3K	B3K	B3K	B3K	B3K																			
MM3-20 J BORE				B3K	B3K	B3K	B3K	B3K	B3K	B3K																		
MM4-20 J BORE										B3K	B3K	B3K	B3K	B3K	B3K	B3K												
MM5-20 J BORE												B3K	B3K	B3K	B3K	B3K	B3K	B3K										
MM2-25 J BORE	B3K	B3K	B3K	B3K	B3K	B3K	B3K	B3K																				
MM2.5-25 J BORE				B3K	B3K	B3K	B3K	B3K	B3K	B3K																		
MM3-25 J BORE										B3K	B3K	B3K	B3K	B3K														
MM4-25 J BORE												B3K	B3K	B3K	B3K	B3K	B3K	B3K	B3K									
MM5-25 J BORE															B3K	B3K	B3K	B3K	B3K	B3K	B3K	B3K	B3K	B3K				
MM2-30 J BORE	B3K	B3K	B3K	B3K	B3K	B3K	B3K	B3K	B3K	B3K																		
MM2.5-30 J BORE				B3K	B3K	B3K	B3K	B3K	B3K	B3K	B3K																	
MM3-30 J BORE												B3K	B3K	B3K	B3K	B3K	B3K	B3K	B3K									
MM4-30 J BORE																B3K	B3K	B3K	B3K	B3K	B3K	B3K	B3K	B3K				
MM5-30 J BORE																	B3K	B3K	B3K	B3K	B3K	B3K	B3K	B3K				

LM Module 0.8~1.5
Sintered Metal Miter Gears



Specifications	
Precision grade	JIS B 1704: 1978 grade 5
Gear teeth	Gleason
Pressure angle	20°
Material	SMF5040
Heat treatment	—
Tooth hardness	(70 to 95HRB)

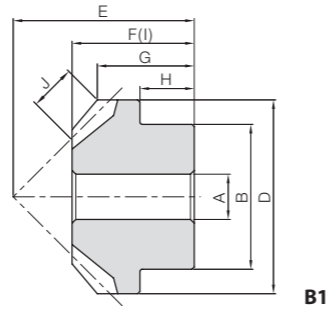

B1

Catalog Number	Gear Ratio	Module	No. of teeth	Shape	Bore H ₈													Allowable torque (N·m)				Allowable torque (kgf·m)				Backlash (mm)	Weight (g)	Catalog Number
					A _{H8}	B	C	D	E	F	G	H	I	J	K	L	M	N	O	P	Q	R	S	T				
LM0.8-20	1	<i>m0.8</i>	20	B1	4	12	16	17.13	16	11	8.57	5.5									0.22	0.027	0.022	0.0027	0~0.16	9.67	LM0.8-20	
LM1-20		<i>m1</i>			5	16	20	21.41	20	13.5	10.71	6									0.41	0.050	0.042	0.0051	0~0.18	20.7	LM1-20	
LM1.25-20		<i>m1.25</i>			6	22	25	26.77	23	15	11.38	6									0.81	0.099	0.083	0.010	0~0.20	38.8	LM1.25-20	
LM1.5-20		<i>m1.5</i>			6	26	30	32.12	30	21	16.06	9									1.48	0.19	0.15	0.019	0~0.22	78.6	LM1.5-20	

Hole length	Face width	Holding surface dia.	Allowable torque (N·m)		Allowable torque (kgf·m)		Backlash (mm)	Weight (g)	Catalog Number
			Bending strength	Surface durability	Bending strength	Surface durability			
11	4.24	—	0.22	0.027	0.022	0.0027	0~0.16	9.67	LM0.8-20
13.5	4.95	—	0.41	0.050	0.042	0.0051	0~0.18	20.7	LM1-20
15	6.36	—	0.81	0.099	0.083	0.010	0~0.20	38.8	LM1.25-20
21	8.48	—	1.48	0.19	0.15	0.019	0~0.22	78.6	LM1.5-20