

Specifications	
Precision grade	KHK R 001 grade 4 *
Gear teeth	Standard full depth
Pressure angle	20°
Material	SCM440
Heat treatment	Thermal refining only
Tooth hardness	225 ~ 285HB * *
Surface treatment	Black oxide coating

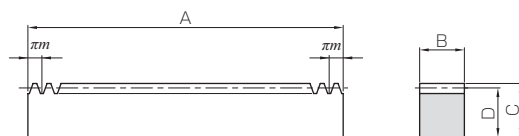

RF

* The precision grade of these products is equivalent to the value shown in the table.
 ** Due to the decarburization layer of about 0.5 mm thickness, the rectangular surface have (less than HB187) hardness.

J Series

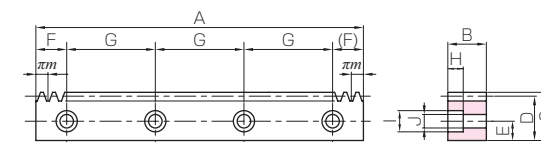

RD

Thermal Refined Racks

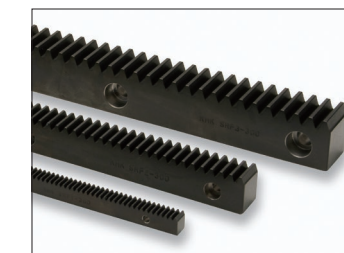

Catalog No.	Module	No. of teeth	Shape	Total length				Allowable force (N)		Allowable force (kgf)		Weight (kg)
				A	B	C	D	Bending strength	Surface durability	Bending strength	Surface durability	
KRF1.5-500 KRF1.5-1000	m1.5	106 212	RF	499.51 999.03	15	20	18.5	3450	953	352	97.2	1.09 2.18
KRF2-500 KRF2-1000	m2	80 160	RF	502.65 1005.31	20	25	23	6130	1760	625	179	1.82 3.63
KRF2.5-500 KRF2.5-1000	m2.5	64 128	RF	502.65 1005.31	25	30	27.5	9580	2810	977	287	2.71 5.43
KRF3-500 KRF3-1000	m3	53 106	RF	499.51 999.03	30	35	32	13800	4120	1410	421	3.76 7.53
KRF4-500 KRF4-1000	m4	40 80	RF	502.65 1005.31	40	45	41	24500	7530	2500	768	6.47 12.9
KRF5-500 KRF5-1000	m5	32 64	RF	502.65 1005.31	50	50	45	38300	12000	3910	1220	8.88 17.8

Catalog No. ● : J Series (Available-on-request)	Module	No. of teeth	Shape	Total length				Mounting hole dimensions			No. of mounting holes	Mounting screw size
				A	B	C	D	E	F	G		
● KRFD1.5-500J ● KRFD1.5-1000J	m1.5	106 212	RD	499.51 999.03	15	20	18.5	8	24.76 49.51	150 180	4 6	M5
● KRFD2-500J ● KRFD2-1000J	m2	80 160		502.65 1005.31	20	25	23	10	26.33 52.65	150 180	4 6	M6
● KRFD2.5-500J ● KRFD2.5-1000J	m2.5	64 128		502.65 1005.31	25	30	27.5	12	26.33 52.65	150 180	4 6	M8
● KRFD3-500J ● KRFD3-1000J	m3	53 106		499.51 999.03	30	35	32	14	24.76 49.51	150 180	4 6	M10
● KRFD4-500J ● KRFD4-1000J	m4	40 80		502.65 1005.31	40	45	41	18	26.33 52.65	150 180	4 6	M12
● KRFD5-500J ● KRFD5-1000J	m5	32 64		502.65 1005.31	50	50	45	20	31.33 62.65	220	3 5	M14

[Caution on Product Characteristics] ① The allowable forces shown in the table are the calculated values according to the assumed usage conditions. Please see Page 190 for more details.
 ② The backlash of racks differ depending on the size of the mating pinion. Please calculate the backlash from the backlash value of the mating pinion. Also, please refer to the data in the section called 'Backlash of Rack Tooth (Amount of Tooth Thinning)' on Page 193.

[Caution on Secondary Operations] ① Please read "Caution on Performing Secondary Operations" (Page 194) when performing modifications and/or secondary operations for safety concerns. KHK Quick-Mod Gears, the KHK's system for quick modification of KHK stock gears is also available.
 ② If gear tooth hardening, or thermal refining, is applied, the decarburization layer (approx. 0.5 mm thickness) on the rectangular surfaces cannot have the hardness you designate.

[Caution on J series] ① As available-on-request products, requires a lead-time for shipping within **2 working-days (excludes the day ordered), after placing an order.** Please allow additional shipping time to get to your local distributor.
 ② Number of products we can process for one order is **1 to 20 units.** For quantities of 21 or more pieces, we need to quote price and lead time.
 ③ No black oxide is re-applied after adding secondary operation of adding mounting holes.

Counterbore dimensions			Allowable force (N)		Allowable force (kgf)		Weight (kg)	Catalog No. ● : J Series (Available-on-request)
H	I	J	Bending strength	Surface durability	Bending strength	Surface durability		
6	10	6	3450	953	352	97.2	1.07 2.14	● KRFD1.5-500J ● KRFD1.5-1000J
7	11	7	6130	1760	625	179	1.78 3.58	● KRFD2-500J ● KRFD2-1000J
8.6	14	9	9580	2810	977	287	2.64 5.31	● KRFD2.5-500J ● KRFD2.5-1000J
10.8	17.5	11	13800	4120	1410	421	3.63 7.32	● KRFD3-500J ● KRFD3-1000J
13	20	14	24500	7530	2500	768	6.21 12.6	● KRFD4-500J ● KRFD4-1000J
15.2	23	16	38300	12000	3910	1220	8.56 17.2	● KRFD5-500J ● KRFD5-1000J

Recommended Mating Pinions

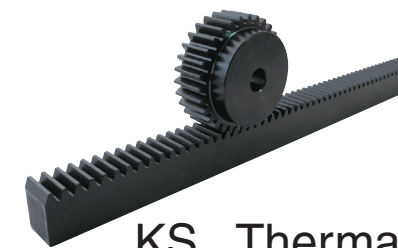

KS Thermal Refined Steel Spur Gears

Please see Page 70 for more details.