

SUW Stainless Steel Worms

Module 0.5、0.8

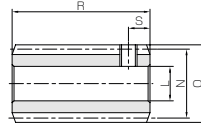

Specifications	
Precision grade	KHK W 001 grade 4
Reference section of gear	Normal plane
Gear teeth	Standard full depth
Normal pressure angle	20°
Material	SUS303
Heat treatment	—
Tooth hardness	(less than 187HB)



W2

Catalog No.	Normal module	Number of starts	Lead angle	Hand thread	Shape	Bore L _H	Hub dia. M	Pitch dia. N	Outside dia. O	Face width P	Hub width Q	Total length R
SUW0.5-R1	m0.5	1	2°36'	R	W2	5	—	11	12	—	—	18
SUW0.5-R2		2	5°13'	R	W2	5	—	11	12	—	—	18
SUW0.8-R1	m0.8	1	3°17'	R	W2	6	—	14	15.6	—	—	30
SUW0.8-R2		2	6°34'	R	W2	6	—	14	15.6	—	—	30

[Caution on Product Characteristics] ① For W2-shaped products, a set screw is included. When setting up the mating wheel, make sure no friction occurs within the set screw.
② These worms produce axial thrust forces. See Page 344 for more details.

* For products not categorized in our KHK Stock Gear series, custom gear production services with **short lead times** is available. For details see Page 8.

DG Plastic Worm Wheels

Module 0.5、0.8



Specifications	
Precision grade	KHK W 002 grade 5
Reference section of gear	Normal plane
Gear teeth	Standard full depth
Normal pressure angle	20°
Material	Polyacetal
Heat treatment	—
Tooth hardness	—

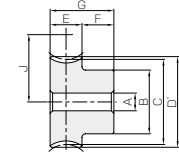

HA

Catalog No.	Reduction ratio	Normal module	No. of teeth	Number of starts	Helix angle	Hand thread	Shape	Bore		Hub dia. B	Pitch dia. C	Throat dia. D	Outside dia. D'	Face width E
								A	-0.05/-0.10					
DG0.5-20R1	20	m0.5	20	1	2°36'	R	HA	4	9	10.01	—	11	5	
DG0.5-20R2	10		20	2	5°13'	R	HA	4	9	10.04	—	11	5	
DG0.5-30R1	30		30	1	2°36'	R	HA	4	12	15.02	—	16	5	
DG0.5-30R2	15		30	2	5°13'	R	HA	4	12	15.06	—	16	5	
DG0.5-40R1	40		40	1	2°36'	R	HA	5	15	20.02	—	21	5	
DG0.5-50R1	50		50	1	2°36'	R	HA	5	20	25.03	—	26	5	
DG0.5-60R1	60	60	1	2°36'	R	HA	5	25	30.03	—	31	5		
DG0.8-20R1	20	m0.8	20	1	3°17'	R	HA	5	12	16.03	—	17.6	9	
DG0.8-20R2	10		20	2	6°34'	R	HA	5	12	16.11	—	17.6	9	
DG0.8-30R1	30		30	1	3°17'	R	HA	5	18	24.04	—	25.6	9	
DG0.8-30R2	15		30	2	6°34'	R	HA	5	18	24.16	—	25.6	9	
DG0.8-40R1	40		40	1	3°17'	R	HA	6	20	32.05	—	33.6	9	
DG0.8-50R1	50		50	1	3°17'	R	HA	8	25	40.07	—	41.6	9	
DG0.8-60R1	60	60	1	3°17'	R	HA	8	25	48.08	—	49.6	9		

[Caution on Product Characteristics] ① Worm Wheels are profile shifted to create the proper center distance.
② The allowable torques shown in the table are the calculated values according to the assumed usage conditions. Please see Page 342 for more details.
③ Since the bore is finished with a minus tolerance, you can use a shaft with a force fit.

SUW

Stainless Steel Worms

Set Screw		Weight (kg)	Catalog No.
Size	S		
M3	3	0.010	SUW0.5-R1
M3	3	0.010	SUW0.5-R2
M4	5	0.029	SUW0.8-R1
M4	5	0.029	SUW0.8-R2

[Caution on Secondary Operations] ① Please read "Caution on Performing Secondary Operations" (Page 344) when performing modifications and/or secondary operations for safety concerns. KHK Quick-Mod Gears, the KHK's system for quick modification of KHK stock gears is also available.

DG

Plastic Worm Wheels



Hub width F	Total length G	Mounting distance J	Allowable torque (N·m)		Backlash (mm)	Weight (g)	Catalog No.
			Bending strength	Bending strength			
7	12	10.5	0.067	0.0068	0~0.16	1.01	DG0.5-20R1
7	12	10.5	0.067	0.0069	0~0.16	1.01	DG0.5-20R2
7	12	13	0.11	0.011	0~0.16	2.21	DG0.5-30R1
7	12	13	0.11	0.011	0~0.16	2.21	DG0.5-30R2
7	12	15.5	0.16	0.016	0~0.16	3.72	DG0.5-40R1
7	12	18	0.21	0.022	0~0.16	6.36	DG0.5-50R1
7	12	20.5	0.26	0.027	0~0.16	9.67	DG0.5-60R1
9	18	15	0.31	0.031	0.04~0.22	3.73	DG0.8-20R1
9	18	15	0.31	0.032	0.04~0.22	3.73	DG0.8-20R2
9	18	19	0.52	0.053	0.04~0.22	8.84	DG0.8-30R1
9	18	19	0.52	0.053	0.04~0.22	8.84	DG0.8-30R2
9	18	23	0.74	0.076	0.04~0.22	14.0	DG0.8-40R1
9	18	27	0.98	0.10	0.04~0.22	21.6	DG0.8-50R1
9	18	31	1.21	0.12	0.04~0.22	28.8	DG0.8-60R1

[Caution on Secondary Operations] ① Please read "Caution on Performing Secondary Operations" (Page 344) when performing modifications and/or secondary operations for safety concerns. KHK Quick-Mod Gears, the KHK's system for quick modification of KHK stock gears is also available.