



Specifications	
Precision grade	JIS grade N8 (JIS B1702-1:1998)
Gear teeth	Standard full depth
Pressure angle	14.5°
Material	S45C (equiv. to AISI/SAE 1045)
Heat treatment	-
Tooth hardness	(less than 194HB)
Surface treatment	Black oxide coating

*Comparison of precision grade	
JIS grade N8 (JIS B1702-1:1998)	equivalent to
AGMA 390.03(1973)	
- Pitch tolerance	8
- Profile tolerance	9
- Runout tolerance	9
- Lead tolerance	8

(All dimensions in Inches)

Catalog No.	DP	No. of teeth	Bore		Hub dia.	Pitch dia.	Outside dia.	Face width	Hub width	Total length	Allowable torque (N-m)		Allowable torque (kgf-m)		Weight (lbs)
			A <sub>H7</sub>	B	C	D	E	F	G	Bending strength	Surface durability	Bending strength	Surface durability		
SSDP4PA14.5-18	4	18	1.125	3.75	4.5	5	2	0.875	2.875	573	49.7	58.5	5.06	11	
SSDP4PA14.5-20		20	1.125	4	5	5.5	2	0.875	2.875	795	62.8	81.1	6.4	13.4	
SSDP4PA14.5-24		24	1.125	5	6	6.5	2	1.5	3.5	1362	92.5	139	9.43	23.4	
SSDP4PA14.5-28		28	1.125	5	7	7.5	2	1.5	3.5	1839	128	188	13.1	29.2	
SSDP4PA14.5-30		30	1.25	6	7.5	8	2	1.5	3.5	2027	149	207	15.2	35.9	
SSDP4PA14.5-32		32	1.25	6	8	8.5	2	1.5	3.5	1705	131	174	13.4	39.3	
SSDP4PA14.5-36		36	1.25	6	9	9.5	2	1.5	3.5	2003	169	204	17.2	46.9	
SSDP6PA14.5-18	6	18	1	2.5	3	3.333	1.5	0.875	2.375	191	15.6	19.5	1.59	3.7	
SSDP6PA14.5-20		20	1	2.75	3.333	3.667	1.5	0.875	2.375	265	19.7	27	2.01	4.66	
SSDP6PA14.5-24		24	1.125	3.5	4	4.333	1.5	1	2.5	454	29.3	46.3	2.99	7.37	
SSDP6PA14.5-28		28	1.125	3.5	4.667	5	1.5	1	2.5	613	40.7	62.5	4.15	9.3	
SSDP6PA14.5-30		30	1.125	4	5	5.333	1.5	1	2.5	676	47.1	68.9	4.8	11.2	
SSDP6PA14.5-36		36	1.125	5	6	6.333	1.5	1	2.5	868	69.4	88.5	7.08	16.9	
SSDP6PA14.5-40		40	1.125	5	6.667	7	1.5	1	2.5	999	86.8	102	8.85	19.7	
SSDP6PA14.5-42		42	1.125	5	7	7.333	1.5	1	2.5	1065	96.3	109	9.82	21.2	
SSDP6PA14.5-48		48	1.125	5	8	8.333	1.5	1	2.5	974	98.5	99.4	10	26.2	
SSDP6PA14.5-52		52	1.125	5	8.667	9	1.5	1	2.5	1079	117	110	11.9	30	
SSDP8PA14.5-18	8	18	0.875	1.75	2.25	2.5	1.25	0.75	2	89.6	6.96	9.13	0.71	1.58	
SSDP8PA14.5-20		20	0.875	2	2.5	2.75	1.25	0.75	2	124	8.82	12.7	0.9	2.07	
SSDP8PA14.5-24		24	0.875	2.5	3	3.25	1.25	1	2.25	213	13.2	21.7	1.35	3.51	
SSDP8PA14.5-28		28	0.875	3	3.5	3.75	1.25	1	2.25	287	18.4	29.3	1.88	5.03	
SSDP8PA14.5-30		30	0.875	3	3.75	4	1.25	1	2.25	317	21.3	32.3	2.17	5.54	
SSDP8PA14.5-32		32	1	3.5	4	4.25	1.25	1	2.25	346	24.4	35.3	2.49	6.68	
SSDP8PA14.5-36		36	1	3.5	4.5	4.75	1.25	1	2.25	407	31.4	41.5	3.2	7.87	
SSDP8PA14.5-40		40	1	3.5	5	5.25	1.25	1	2.25	468	39.3	47.8	4	9.19	
SSDP8PA14.5-48		48	1	3.5	6	6.25	1.25	1	2.25	594	57.8	60.6	5.9	12.3	
SSDP8PA14.5-52		52	1	4	6.5	6.75	1.25	1	2.25	658	68.6	67.1	6.99	14.8	
SSDP8PA14.5-60		60	1	4	7.5	7.75	1.25	1	2.25	787	93	80.2	9.48	18.7	
SSDP8PA14.5-68		68	1	5	8.5	8.75	1.25	1	2.25	706	93.4	72	9.53	25.2	
SSDP8PA14.5-72		72	1	5	9	9.25	1.25	1	2.25	756	106	77.1	10.8	27.6	
SSDP10PA14.5-18	10	18	0.75	1.5	1.8	2	1	0.625	1.625	45.9	3.48	4.68	0.35	0.83	
SSDP10PA14.5-20		20	0.75	1.625	2	2.2	1	0.625	1.625	63.6	4.4	6.48	0.45	1.05	
SSDP10PA14.5-24		24	0.75	2	2.4	2.6	1	0.625	1.625	109	6.61	11.1	0.67	1.64	
SSDP10PA14.5-25		25	0.75	2	2.5	2.7	1	0.625	1.625	122	7.23	12.5	0.74	1.82	
SSDP10PA14.5-30		30	0.75	2.125	3	3.2	1	0.875	1.875	162	10.6	16.5	1.08	2.65	
SSDP10PA14.5-32		32	0.75	2.125	3.2	3.4	1	0.875	1.875	177	12.2	18.1	1.24	2.93	
SSDP10PA14.5-36		36	0.75	2.125	3.6	3.8	1	0.875	1.875	208	15.6	21.2	1.6	3.53	
SSDP10PA14.5-40		40	0.875	2.5	4	4.2	1	0.875	1.875	240	19.6	24.4	1.99	4.46	
SSDP10PA14.5-45		45	0.875	2.5	4.5	4.7	1	0.875	1.875	280	25.1	28.5	2.56	5.41	
SSDP10PA14.5-48		48	0.875	2.5	4.8	5	1	0.875	1.875	304	28.8	31	2.94	6.03	
SSDP10PA14.5-50		50	0.875	2.5	5	5.2	1	0.875	1.875	320	31.4	32.7	3.2	6.47	
SSDP10PA14.5-60		60	0.875	3	6	6.2	1	0.875	1.875	403	46.3	41.1	4.72	9.45	
SSDP10PA14.5-70		70	0.875	3	7	7.2	1	0.875	1.875	487	64.2	49.6	6.55	12.3	
SSDP10PA14.5-72		72	0.875	3.5	7.2	7.4	1	0.875	1.875	503	68.2	51.3	6.95	13.6	
SSDP10PA14.5-80		80	0.875	4	8	8.2	1	0.875	1.875	439	65.7	44.8	6.7	17.1	
SSDP10PA14.5-90		90	0.875	5	9	9.2	1	0.875	1.875	505	84.4	51.5	8.61	22.6	

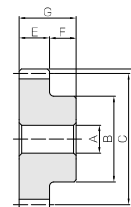

(All dimensions in Inches)

Catalog No.	DP	No. of teeth	Bore	Hub dia.	Pitch dia.	Outside dia.	Face width	Hub width	Total length	Allowable torque (N·m)		Allowable torque (kgf·m)		Weight (lbs)
			A <sub>H7</sub>	B	C	D	E	F	G	Bending strength	Surface durability	Bending strength	Surface durability	
SSDP12PA14.5-18	12	18	0.625	1.25	1.5	1.667	0.75	0.5	1.25	23.9	1.8	2.44	0.18	0.44
SSDP12PA14.5-20		20	0.625	1.406	1.667	1.833	0.75	0.5	1.25	33.1	2.27	3.38	0.23	0.58
SSDP12PA14.5-22		22	0.625	1.5	1.833	2	0.75	0.5	1.25	44.1	2.81	4.49	0.29	0.7
SSDP12PA14.5-24		24	0.625	1.75	2	2.167	0.75	0.5	1.25	56.7	3.38	5.79	0.35	0.9
SSDP12PA14.5-25		25	0.625	1.75	2.083	2.25	0.75	0.5	1.25	63.8	3.69	6.5	0.38	0.96
SSDP12PA14.5-30		30	0.625	2.25	2.5	2.667	0.75	0.625	1.375	84.5	5.42	8.61	0.55	1.63
SSDP12PA14.5-32		32	0.625	2.25	2.667	2.833	0.75	0.625	1.375	92.4	6.22	9.42	0.63	1.77
SSDP12PA14.5-36		36	0.625	2.5	3	3.167	0.75	0.625	1.375	108	7.98	11.06	0.81	2.25
SSDP12PA14.5-40		40	0.625	2.5	3.333	3.5	0.75	0.625	1.375	125	9.97	12.73	1.02	2.61
SSDP12PA14.5-48		48	0.625	2.5	4	4.167	0.75	0.75	1.5	158	14.7	16.15	1.5	3.59
SSDP12PA14.5-60		60	0.75	3	5	5.167	0.75	0.75	1.5	210	23.6	21.39	2.4	5.49
SSDP12PA14.5-72		72	0.75	3.5	6	6.167	0.75	0.75	1.5	262	34.7	26.74	3.54	7.87
SSDP12PA14.5-84	84	0.75	3.5	7	7.167	0.75	0.75	1.5	315	48.2	32.15	4.91	10	
SSDP12PA14.5-96	96	0.75	4	8	8.167	0.75	0.75	1.5	284	49.2	28.93	5.02	13.2	
SSDP12PA14.5-100	100	0.75	4.5	8.333	8.5	0.75	0.75	1.5	298	53.7	30.34	5.48	14.8	

[Caution on Secondary Operations]

- ① Please read "Caution on Performing Secondary Operations" when performing modifications and/or secondary operations for safety concerns. KHK Quick-Mod Gears, the KHK's system for quick modification of KHK stock gears is also available.
- ② Avoid performing secondary operations that narrow the tooth width as it affects precision and strength.

[Caution on Product Characteristics] ① The allowable torques shown in the table are calculated values according to the assumed usage conditions.

② The backlash values shown in the table are the theoretical values for the backlash in the normal direction of a pair of identical gears in mesh.

This type of gear is made-to-order.  
Please contact your KHK distributor for a price quotation.



Specifications	
Precision grade	JIS grade N8 (JIS B1702-1:1998)
Gear teeth	Standard full depth
Pressure angle	20°
Material	S45C (equiv. to AISI/SAE 1045)
Heat treatment	-
Tooth hardness	(less than 194HB)
Surface treatment	Black oxide coating

*Comparison of precision grade	
JIS grade N8 (JIS B1702-1:1998)	
equivalent to	
AGMA 390.03(1973)	
- Pitch tolerance	8
- Profile tolerance	9
- Runout tolerance	9
- Lead tolerance	8

(All dimensions in Inches)

Catalog No.	DP	No. of teeth	Bore		Pitch dia.	Outside dia.	Face width	Hub width	Total length	Allowable torque (N-m)		Allowable torque (kgf-m)		Weight (lbs)
			A <sub>H7</sub>	B						Bending strength	Surface durability	Bending strength	Surface durability	
SSDP4PA20-18	4	18	1.125	3.75	4.5	5	2	0.875	2.875	1007	65.9	103	6.71	11
SSDP4PA20-20		20	1.125	4	5	5.5	2	0.875	2.875	1179	83.3	120	8.49	13.4
SSDP4PA20-24		24	1.125	5	6	6.5	2	1.5	3.5	1532	123	156	12.5	23.4
SSDP4PA20-28		28	1.125	5	7	7.5	2	1.5	3.5	1895	170	193	17.4	29.2
SSDP4PA20-30		30	1.25	6	7.5	8	2	1.5	3.5	2079	197	212	20.1	35.9
SSDP4PA20-32		32	1.25	6	8	8.5	2	1.5	3.5	1743	174	178	17.8	39.3
SSDP4PA20-36		36	1.25	6	9	9.5	2	1.5	3.5	2032	224	207	22.8	46.9
SSDP6PA20-18	6	18	1	2.5	3	3.333	1.5	0.875	2.375	336	20.6	34.2	2.1	3.7
SSDP6PA20-20		20	1	2.75	3.333	3.667	1.5	0.875	2.375	393	26.1	40.1	2.66	4.66
SSDP6PA20-24		24	1.125	3.5	4	4.333	1.5	1	2.5	511	38.9	52.1	3.97	7.37
SSDP6PA20-28		28	1.125	3.5	4.667	5	1.5	1	2.5	632	53.9	64.4	5.5	9.3
SSDP6PA20-30		30	1.125	4	5	5.333	1.5	1	2.5	693	62.5	70.7	6.37	11.2
SSDP6PA20-36		36	1.125	5	6	6.333	1.5	1	2.5	881	92	89.8	9.38	16.9
SSDP6PA20-40		40	1.125	5	6.667	7	1.5	1	2.5	1007	115	103	11.7	19.7
SSDP6PA20-42		42	1.125	5	7	7.333	1.5	1	2.5	1071	128	109	13	21.2
SSDP6PA20-48		48	1.125	5	8	8.333	1.5	1	2.5	972	131	99.2	13.3	26.2
SSDP6PA20-52		52	1.125	5	8.667	9	1.5	1	2.5	1072	155	109	15.8	30
SSDP8PA20-18	8	18	0.875	1.75	2.25	2.5	1.25	0.75	2	157	9.23	16.1	0.94	1.58
SSDP8PA20-20		20	0.875	2	2.5	2.75	1.25	0.75	2	184	11.7	18.8	1.19	2.07
SSDP8PA20-24		24	0.875	2.5	3	3.25	1.25	1	2.25	239	17.6	24.4	1.79	3.51
SSDP8PA20-28		28	0.875	3	3.5	3.75	1.25	1	2.25	296	24.4	30.2	2.49	5.03
SSDP8PA20-30		30	0.875	3	3.75	4	1.25	1	2.25	325	28.3	33.1	2.88	5.54
SSDP8PA20-32		32	1	3.5	4	4.25	1.25	1	2.25	354	32.4	36.1	3.31	6.68
SSDP8PA20-36		36	1	3.5	4.5	4.75	1.25	1	2.25	413	41.6	42.1	4.24	7.87
SSDP8PA20-40		40	1	3.5	5	5.25	1.25	1	2.25	472	52	48.1	5.31	9.19
SSDP8PA20-48		48	1	3.5	6	6.25	1.25	1	2.25	593	76.7	60.4	7.82	12.3
SSDP8PA20-52		52	1	4	6.5	6.75	1.25	1	2.25	653	90.9	66.6	9.27	14.8
SSDP8PA20-60		60	1	4	7.5	7.75	1.25	1	2.25	776	123	79.1	12.6	18.7
SSDP8PA20-68		68	1	5	8.5	8.75	1.25	1	2.25	692	124	70.5	12.6	25.2
SSDP8PA20-72		72	1	5	9	9.25	1.25	1	2.25	739	140	75.4	14.3	27.6
SSDP10PA20-18	10	18	0.75	1.5	1.8	2	1	0.625	1.625	80.6	4.61	8.22	0.47	0.83
SSDP10PA20-20		20	0.75	1.625	2	2.2	1	0.625	1.625	94.3	5.84	9.62	0.6	1.05
SSDP10PA20-24		24	0.75	2	2.4	2.6	1	0.625	1.625	123	8.76	12.5	0.89	1.64
SSDP10PA20-25		25	0.75	2	2.5	2.7	1	0.625	1.625	130	9.59	13.2	0.98	1.82
SSDP10PA20-30		30	0.75	2.125	3	3.2	1	0.875	1.875	166	14.1	17	1.44	2.65
SSDP10PA20-32		32	0.75	2.125	3.2	3.4	1	0.875	1.875	181	16.2	18.5	1.65	2.93
SSDP10PA20-36		36	0.75	2.125	3.6	3.8	1	0.875	1.875	211	20.7	21.5	2.12	3.53
SSDP10PA20-40		40	0.875	2.5	4	4.2	1	0.875	1.875	242	25.9	24.7	2.64	4.46
SSDP10PA20-45		45	0.875	2.5	4.5	4.7	1	0.875	1.875	280	33.3	28.6	3.39	5.41
SSDP10PA20-48		48	0.875	2.5	4.8	5	1	0.875	1.875	303	38.2	30.9	3.89	6.03
SSDP10PA20-50		50	0.875	2.5	5	5.2	1	0.875	1.875	319	41.6	32.5	4.25	6.47
SSDP10PA20-60		60	0.875	3	6	6.2	1	0.875	1.875	397	61.3	40.5	6.25	9.45
SSDP10PA20-70		70	0.875	3	7	7.2	1	0.875	1.875	476	85.1	48.6	8.68	12.3
SSDP10PA20-72		72	0.875	3.5	7.2	7.4	1	0.875	1.875	492	90.4	50.2	9.22	13.6
SSDP10PA20-80		80	0.875	4	8	8.2	1	0.875	1.875	427	87.1	43.6	8.88	17.1
SSDP10PA20-90		90	0.875	5	9	9.2	1	0.875	1.875	489	112	49.9	11.4	22.6

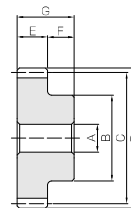

(All dimensions in Inches)

Catalog No.	DP	No. of teeth	Bore		Pitch dia.	Outside dia.	Face width	Hub width	Total length	Allowable torque (N-m)		Allowable torque (kgf-m)		Weight (lbs)
			A <sub>H7</sub>	B						Bending strength	Surface durability	Bending strength	Surface durability	
SSDP12PA20-18	12	18	0.625	1.25	1.5	1.667	0.75	0.5	1.25	42	2.38	4.28	0.24	0.44
SSDP12PA20-20		20	0.625	1.406	1.667	1.833	0.75	0.5	1.25	49.1	3.01	5.01	0.31	0.58
SSDP12PA20-22		22	0.625	1.5	1.833	2	0.75	0.5	1.25	56.4	3.72	5.75	0.38	0.7
SSDP12PA20-24		24	0.625	1.75	2	2.167	0.75	0.5	1.25	63.8	4.49	6.51	0.46	0.9
SSDP12PA20-25		25	0.625	1.75	2.083	2.25	0.75	0.5	1.25	67.6	4.89	6.89	0.5	0.96
SSDP12PA20-30		30	0.625	2.25	2.5	2.667	0.75	0.625	1.375	86.6	7.19	8.84	0.73	1.63
SSDP12PA20-32		32	0.625	2.25	2.667	2.833	0.75	0.625	1.375	94.4	8.24	9.63	0.84	1.77
SSDP12PA20-36		36	0.625	2.5	3	3.167	0.75	0.625	1.375	110	10.6	11.22	1.08	2.25
SSDP12PA20-40		40	0.625	2.5	3.333	3.5	0.75	0.625	1.375	126	13.2	12.84	1.35	2.61
SSDP12PA20-48		48	0.625	2.5	4	4.167	0.75	0.75	1.5	158	19.4	16.11	1.98	3.59
SSDP12PA20-60	12	60	0.75	3	5	5.167	0.75	0.75	1.5	207	31.2	21.1	3.18	5.49
SSDP12PA20-72		72	0.75	3.5	6	6.167	0.75	0.75	1.5	256	46	26.14	4.69	7.87
SSDP12PA20-84		84	0.75	3.5	7	7.167	0.75	0.75	1.5	306	63.9	31.21	6.51	10
SSDP12PA20-96		96	0.75	4	8	8.167	0.75	0.75	1.5	274	65.3	27.93	6.66	13.2
SSDP12PA20-100		100	0.75	4.5	8.333	8.5	0.75	0.75	1.5	287	71.2	29.24	7.26	14.8

[Caution on Secondary Operations]

- ① Please read "Caution on Performing Secondary Operations" when performing modifications and/or secondary operations for safety concerns. KHK Quick-Mod Gears, the KHK's system for quick modification of KHK stock gears is also available.
- ② Avoid performing secondary operations that narrow the tooth width as it affects precision and strength.

[Caution on Product Characteristics] ① The allowable torques shown in the table are calculated values according to the assumed usage conditions.

② The backlash values shown in the table are the theoretical values for the backlash in the normal direction of a pair of identical gears in mesh.

This type of gear is made-to-order.  
Please contact your KHK distributor for a price quotation.