

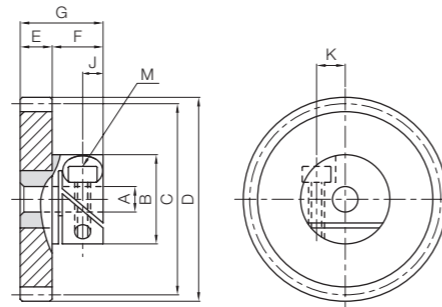

Specifications	
Precision grade	JIS grade N10 (JIS B1702-1: 1998)*
Gear teeth	Standard full depth
Pressure angle	20°
Material	Polyacetal (Hub: SUS303)
Heat Treatment	—
Tooth hardness	(110 to 120HRR)

\* The gear grade listed is the value before clamping.  
The precision grade of products with a module of 0.5 or less is equivalent to the value shown in the table.



S1

Catalog Number	Module	No. of teeth	Shape	Bore				Face width	Hub width	Total length	Hex socket screw		
				A <sub>H7</sub>	B	C	D				E	F	G
<b>DSF0.5-36</b>	<b>m0.5</b>	36	S1	5	14	18	19	5	8.5	13.5	M2.5	3.3	4.4
<b>DSF0.5-40</b>		20				21							
<b>DSF0.5-48</b>		24				25							
<b>DSF0.5-50</b>		25				26							
<b>DSF0.5-60</b>		30				31							
<b>DSF0.5-80</b>		40				41							
<b>DSF0.5-120</b>	120	60	61	10	15	M3	4.5	6					
<b>DSF1-20</b>	<b>m1</b>	20	S1	5	14	20	22	6	8.5	14.5	M2.5	3.3	4.4
<b>DSF1-24</b>		24				26							
<b>DSF1-25</b>		25				27							
<b>DSF1-28</b>		28				30							
<b>DSF1-30</b>		30				32							
<b>DSF1-32</b>		32				34							
<b>DSF1-35</b>		35		37									
<b>DSF1-36</b>		36		38									
<b>DSF1-40</b>		40		42									
<b>DSF1-45</b>		45		47									
<b>DSF1-48</b>	48	50	8	19	48	50	10	16	M3	4.5	6		
<b>DSF1-50</b>	50	52											
<b>DSF1-60</b>	60	62											
<b>DSF1-64</b>	64	66											
<b>DSF1-80</b>	80	82											
<b>DSF1-90</b>	90	92											
<b>DSF1-100</b>	100	100	102										

Allowable torque (N·m)	Allowable torque (kgf·m)	Ref. slipping torque	Standard screw tightening torque (N·m)	Backlash (mm)	Weight (g)	Catalog Number
0.49	0.050	0.62	0.45	0~0.10	11.7	<b>DSF0.5-36</b>
0.55	0.057				12.1	<b>DSF0.5-40</b>
0.69	0.071				13.1	<b>DSF0.5-48</b>
0.73	0.075				13.4	<b>DSF0.5-50</b>
0.90	0.092				14.9	<b>DSF0.5-60</b>
1.25	0.13				18.8	<b>DSF0.5-80</b>
1.93	0.20	2.22	0.80	40.1	<b>DSF0.5-120</b>	
0.96	0.098	0.62	0.45	0~0.10	12.7	<b>DSF1-20</b>
1.22	0.12				13.9	<b>DSF1-24</b>
1.28	0.13				14.2	<b>DSF1-25</b>
1.48	0.15				15.3	<b>DSF1-28</b>
1.61	0.16				26.5	<b>DSF1-30</b>
1.75	0.18				27.3	<b>DSF1-32</b>
1.96	0.20	28.7	<b>DSF1-35</b>			
2.04	0.21	29.1	<b>DSF1-36</b>			
2.33	0.24	31.2	<b>DSF1-40</b>			
2.69	0.27	34.0	<b>DSF1-45</b>			
2.92	0.30	2.22	0.80	35.8	<b>DSF1-48</b>	
3.07	0.31			37.1	<b>DSF1-50</b>	
3.78	0.39			44.5	<b>DSF1-60</b>	
4.07	0.41			47.7	<b>DSF1-64</b>	
5.23	0.53			63.1	<b>DSF1-80</b>	
5.95	0.61			74.4	<b>DSF1-90</b>	
6.68	0.68	87.0	<b>DSF1-100</b>			