



SRO · SROS Steel Round Racks



Module 1 ~ 6

Round Racks



| Specifications | |
|-----------------|---------------------|
| Precision grade | KHK R 001 grade 4 |
| Gear teeth | Standard full depth |
| Pressure angle | 20° |
| Material | S45C |
| Heat treatment | — |
| Tooth hardness | (less than 95HRB) |

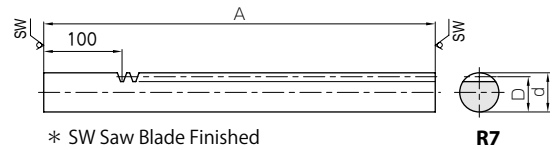
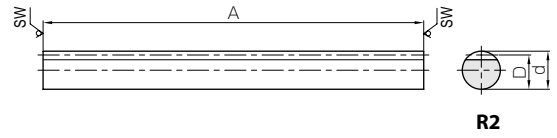

* SW Saw Blade Finished

| Catalog No. | Module | Effective no. of teeth | Shape | Total length | | | Allowable force (N) | | Allowable force (kgf) | | Weight (kg) |
|---|-------------|------------------------|-------|--------------|-----------------------|------------------------|---------------------|--------------------|-----------------------|--------------------|--------------|
| | | | | A | Outside dia. d_{h9} | Height to pitch line D | Bending strength | Surface durability | Bending strength | Surface durability | |
| SRO1-500 | m1 | 159 | R2 | 505 | 10 | 9 | 800 | 121 | 81.6 | 12.3 | 0.29 |
| SRO1.5-500 | m1.5 | 105 | R2 | 505 | 15 | 13.5 | 1800 | 288 | 184 | 29.3 | 0.65 |
| SRO2-500 SRO2-1000 | m2 | 79 159 | R2 | 505 1010 | 20 | 18 | 3200 | 530 | 326 | 54.0 | 1.16 2.31 |
| SRO2.5-500 SRO2.5-1000 | m2.5 | 63 127 | R2 | 505 1010 | 25 | 22.5 | 5000 | 848 | 510 | 86.5 | 1.81 3.61 |
| SRO3-500 SRO3-1000 | m3 | 52 105 | R2 | 505 1010 | 30 | 27 | 7200 | 1240 | 735 | 127 | 2.60 5.20 |
| SRO4-500 SRO4-1000 | m4 | 39 79 | R2 | 505 1010 | 40 | 36 | 12800 | 2270 | 1310 | 232 | 4.62 9.24 |
| SRO5-1000 | m5 | 63 | R2 | 1010 | 50 | 45 | 20000 | 3620 | 2040 | 369 | 14.4 |
| SRO6-1000 | m6 | 52 | R2 | 1010 | 60 | 54 | 28800 | 5290 | 2940 | 539 | 20.8 |

| Catalog No. | Module | Effective no. of teeth | Shape | Total length | | | Allowable force (N) | | Allowable force (kgf) | | Weight (kg) |
|--------------------|-------------|------------------------|-------|--------------|-----------------------|------------------------|---------------------|--------------------|-----------------------|--------------------|-------------|
| | | | | A | Outside dia. d_{h9} | Height to pitch line D | Bending strength | Surface durability | Bending strength | Surface durability | |
| SROS1-500 | m1 | 128 | R7 | 505 | 10 | 9 | 800 | 121 | 81.6 | 12.3 | 0.29 |
| SROS1.5-500 | m1.5 | 85 | R7 | 505 | 15 | 13.5 | 1800 | 288 | 184 | 29.3 | 0.66 |
| SROS2-500 | m2 | 64 | R7 | 505 | 20 | 18 | 3200 | 530 | 326 | 54.0 | 1.17 |
| SROS2.5-500 | m2.5 | 51 | R7 | 505 | 25 | 22.5 | 5000 | 848 | 510 | 86.5 | 1.83 |
| SROS3-500 | m3 | 42 | R7 | 505 | 30 | 27 | 7200 | 1240 | 735 | 127 | 2.64 |

- [Caution on Product Characteristics]
- The allowable forces shown in the table are the calculated values according to the assumed usage conditions. Please see Page 189 for more details.
 - The backlash of racks differ depending on the size of the mating pinion. Please calculate the backlash from the backlash value of the mating pinion. Also, please refer to the data in the section called 'Backlash of Rack Tooth (Amount of Tooth Thinning)' on Page 191.
 - Tolerance of "d" dimension of SRO6-1000 is h10.
- [Caution on Secondary Operations]
- Please read "Caution on Performing Secondary Operations" (Page 192) when performing modifications and/or secondary operations for safety concerns. KHK Quick-Mod Gears, the KHK's system for quick modification of KHK stock gears is also available.
 - Please avoid hardening of Round Racks. It causes contortion and deformation, and straightening processes can hardly be applied.



SURO Stainless Steel Round Racks



Module 1 ~ 3

Stainless Steel Round Racks



| Specifications | |
|-----------------|---------------------|
| Precision grade | KHK R 001 grade 5 |
| Gear teeth | Standard full depth |
| Pressure angle | 20° |
| Material | SUS303 |
| Heat treatment | — |
| Tooth hardness | (less than 187HB) |

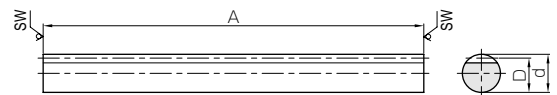

* SW Saw Blade Finished

R2

| Catalog No. | Module | Effective no. of teeth | Shape | Total length | | | Allowable force (N) | | Allowable force (kgf) | | Weight (kg) |
|---|-------------|------------------------|-------|--------------|-----------------------|------------------------|---------------------|--------------------|-----------------------|--------------------|--------------|
| | | | | A | Outside dia. d_{h9} | Height to pitch line D | Bending strength | Surface durability | Bending strength | Surface durability | |
| SURO1-500 | m1 | 159 | R2 | 505 | 10 | 9 | 382 | 67.9 | 39.0 | 6.93 | 0.29 |
| SURO1.5-500 | m1.5 | 105 | R2 | 505 | 15 | 13.5 | 859 | 162 | 87.6 | 16.5 | 0.65 |
| SURO2-500 SURO2-1000 | m2 | 79 159 | R2 | 505 1010 | 20 | 18 | 1530 | 298 | 156 | 30.4 | 1.15 2.30 |
| SURO2.5-500 SURO2.5-1000 | m2.5 | 63 127 | R2 | 505 1010 | 25 | 22.5 | 2390 | 477 | 243 | 48.7 | 1.79 3.59 |
| SURO3-500 SURO3-1000 | m3 | 52 105 | R2 | 505 1010 | 30 | 27 | 3440 | 700 | 351 | 71.4 | 2.58 5.17 |

- [Caution on Product Characteristics]
- The allowable forces shown in the table are the calculated values according to the assumed usage conditions. Please see Page 189 for more details.
 - The backlash of racks differ depending on the size of the mating pinion. Please calculate the backlash from the backlash value of the mating pinion. Also, please refer to the data in the section called 'Backlash of Rack Tooth (Amount of Tooth Thinning)' on Page 191.
- [Caution on Secondary Operations]
- Please read "Caution on Performing Secondary Operations" (Page 192) when performing modifications and/or secondary operations for safety concerns. KHK Quick-Mod Gears, the KHK's system for quick modification of KHK stock gears is also available.

Spur Gears

Helical Gears

Internal Gears

Racks

CP Racks & Pinions

Miter Gears

Bevel Gears

Screw Gears

Worm Gear Pair

Bevel Gearboxes

Other Products