

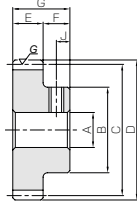

Specifications	
Precision grade	JIS grade N7 (JIS B1702-1:1998) JIS grade 3 (JIS B1702:1976)
Gear teeth	Standard full depth
Pressure angle	20°
Material	S45C *
Heat treatment	— *
Tooth hardness	200 ~ 270HB



S1T

* Tooth areas, where size is less than 0.8 module, without quenching treatment.

Catalog No.	Module	No. of teeth	Shape	Bore			Outside dia.	Face width	Hub width	Total length	Keyway
				A _{H7}	B	C					
SSG0.5-30A SSG0.5-30B	m0.5	30	S1T	5	13	15	16	5	7	12	—
			S1T	6							
SSG0.5-32A		32	S1T	5	14	16	17	5	7	12	—
SSG0.5-34A			34	S1T	5	15	17	18	5	7	12
SSG0.5-35A		35		S1T	5	15	17.5	18.5	5	7	12
SSG0.5-36A			36	S1T	5	16	18	19	5	7	12
SSG0.5-38A		38		S1T	5	16	19	20	5	7	12
SSG0.5-40A SSG0.5-40B			40	S1T	5	18	20	21	5	7	12
		S1T		6							
SSG0.5-50A SSG0.5-50B		50	S1T	5	22	25	26	5	7	12	—
			S1T	6							
SSG0.5-60A SSG0.5-60B		60	S1T	6	28	30	31	5	7	12	—
			S1T	8							
SSG0.5-70A SSG0.5-70B		70	S1T	6	28	35	36	5	7	12	—
			S1T	8							
SSG0.5-80A SSG0.5-80B		80	S1T	6	28	40	41	5	7	12	—
	S1T		8								
SSG0.8-20A SSG0.8-20B	m0.8	20	S1T	5	13	16	17.6	8	8	16	—
			S1T	6							
SSG0.8-21A		21	S1T	6	14	16.8	18.4	8	8	16	—
SSG0.8-22A			22	S1T	6	15	17.6	19.2	8	8	16
SSG0.8-23A		23		S1T	6	15	18.4	20	8	8	16
			S1T	6							
SSG0.8-24A SSG0.8-24B		24	S1T	5	16	19.2	20.8	8	8	16	—
			S1T	6							
SSG0.8-25A SSG0.8-25B		25	S1T	5	16	20	21.6	8	8	16	—
			S1T	6							
SSG0.8-26A		26	S1T	6	18	20.8	22.4	8	8	16	—
SSG0.8-27A			27	S1T	6	18	21.6	23.2	8	8	16
SSG0.8-28A		28		S1T	6	18	22.4	24	8	8	16
SSG0.8-29A			29	S1T	6	20	23.2	24.8	8	8	16
		S1T		6							
SSG0.8-30A SSG0.8-30B SSG0.8-30C		30	S1T	5	20	24	25.6	8	8	16	—
	S1T		6								
SSG0.8-32A	32	S1T	6	22	25.6	27.2	8	8	16	—	
SSG0.8-34A		34	S1T	6	22	27.2	28.8	8	8	16	—
SSG0.8-35A	35		S1T	6	25	28	29.6	8	8	16	—
SSG0.8-36A		36	S1T	6	25	28.8	30.4	8	8	16	—
SSG0.8-38A	38		S1T	6	25	30.4	32	8	8	16	—
		S1T	6								
SSG0.8-40A SSG0.8-40B	40	S1T	6	28	32	33.6	8	8	16	—	
		S1T	8								
SSG0.8-50A SSG0.8-50B	50	S1T	6	28	40	41.6	8	8	16	—	
		S1T	8								
SSG0.8-60A SSG0.8-60B	60	S1T	6	28	48	49.6	8	8	16	—	
		S1T	8								
SSG0.8-70A SSG0.8-70B	70	S1T	6	28	56	57.6	8	8	16	—	
		S1T	8								
SSG0.8-80A SSG0.8-80B	80	S1T	6	28	64	65.6	8	8	16	—	
		S1T	8								

- [Caution on Product Characteristics]
- ① For products with a tapped hole, a set screw is included.
 - ② The allowable torques shown in the table are calculated values according to the assumed usage conditions. Please see Page 31 for more details.
 - ③ The backlash values shown in the table are the theoretical values for the backlash in the normal direction of a pair of identical gears in mesh.
 - ④ The use of S1T shaped set screws for fastening gears to a shaft, is a method only applicable to light load usage. For secure fastening, please use dowel pins, in combination.

Set Screw	Size	J	Allowable torque (N·m)		Allowable torque (kgf·m)		Backlash (mm)	Weight (kg)	Catalog No.
			Bending strength	Surface durability	Bending strength	Surface durability			
M4	3.5	1.63	0.29	0.17	0.030	0~0.08	0.012	SSG0.5-30A SSG0.5-30B	
M4	3.5	1.78	0.34	0.18	0.035	0~0.08	0.014	SSG0.5-32A	
M4	3.5	1.93	0.39	0.20	0.039	0~0.08	0.016	SSG0.5-34A	
M4	3.5	2.00	0.41	0.20	0.042	0~0.08	0.017	SSG0.5-35A	
M4	3.5	2.08	0.44	0.21	0.045	0~0.08	0.019	SSG0.5-36A	
M4	3.5	2.23	0.49	0.23	0.050	0~0.08	0.020	SSG0.5-38A	
M4	3.5	2.38	0.55	0.24	0.056	0~0.08	0.024 0.023	SSG0.5-40A SSG0.5-40B	
M4	3.5	3.14	0.89	0.32	0.091	0~0.08	0.038 0.037	SSG0.5-50A SSG0.5-50B	
M4	3.5	3.91	1.32	0.40	0.13	0~0.08	0.058 0.056	SSG0.5-60A SSG0.5-60B	
M4	3.5	3.90	1.53	0.40	0.16	0~0.08	0.068 0.066	SSG0.5-70A SSG0.5-70B	
M4	3.5	4.55	2.04	0.46	0.21	0~0.08	0.080 0.077	SSG0.5-80A SSG0.5-80B	
M4	4	3.79	0.53	0.39	0.054	0~0.08	0.018 0.017	SSG0.8-20A SSG0.8-20B	
M4	4	4.08	0.59	0.42	0.060	0~0.08	0.020	SSG0.8-21A	
M4	4	4.36	0.66	0.44	0.067	0~0.08	0.022	SSG0.8-22A	
M4	4	4.64	0.73	0.47	0.074	0~0.08	0.024	SSG0.8-23A	
M4	4	4.93	0.80	0.50	0.082	0~0.08	0.028 0.027	SSG0.8-24A SSG0.8-24B	
M4	4	5.22	0.88	0.53	0.090	0~0.08	0.029 0.028	SSG0.8-25A SSG0.8-25B	
M4	4	5.51	0.96	0.56	0.098	0~0.08	0.033	SSG0.8-26A	
M4	4	5.81	1.04	0.59	0.11	0~0.08	0.035	SSG0.8-27A	
M4	4	6.10	1.12	0.62	0.11	0~0.08	0.037	SSG0.8-28A	
M4	4	6.40	1.21	0.65	0.12	0~0.08	0.042	SSG0.8-29A	
M4	4	6.70	1.30	0.68	0.13	0~0.08	0.045 0.044 0.041	SSG0.8-30A SSG0.8-30B SSG0.8-30C	
M4	4	7.29	1.50	0.74	0.15	0~0.08	0.052	SSG0.8-32A	
M4	4	7.90	1.71	0.81	0.17	0~0.08	0.056	SSG0.8-34A	
M4	4	8.20	1.82	0.84	0.19	0~0.08	0.065	SSG0.8-35A	
M4	4	8.51	1.93	0.87	0.20	0~0.08	0.067	SSG0.8-36A	
M4	4	9.12	2.17	0.93	0.22	0~0.08	0.072	SSG0.8-38A	
M4	4	8.11	2.02	0.83	0.21	0~0.08	0.085 0.082	SSG0.8-40A SSG0.8-40B	
M4	4	10.7	3.26	1.09	0.33	0~0.08	0.11 0.11	SSG0.8-50A SSG0.8-50B	
M4	4	13.3	4.83	1.36	0.49	0~0.08	0.15 0.14	SSG0.8-60A SSG0.8-60B	
M4	4	16.0	6.73	1.63	0.69	0~0.08	0.19 0.19	SSG0.8-70A SSG0.8-70B	
M4	4	18.7	8.97	1.90	0.91	0~0.08	0.24 0.23	SSG0.8-80A SSG0.8-80B	

- [Caution on Secondary Operations]
- ① Please read "Caution on Performing Secondary Operations" (Page 32) when performing modifications and/or secondary operations for safety concerns. KHK Quick-Mod Gears, the KHK's system for quick modification of KHK stock gears is also available.



Specifications	
Precision grade	JIS grade N7 (JIS B1702-1: 1998) = JIS grade 3 (JIS B1702: 1976)
Gear teeth	Standard full depth
Pressure angle	20°
Material	S45C
Heat treatment	Tooth surface induction hardened
Tooth hardness	50 ~ 60HRC
Face width (E)	8
Hub width (F)	10
Total length (G)	18
Screw offset (J)	5

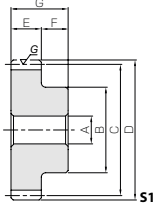

* The precision grade of J Series products is equivalent to the value shown in the table.

Catalog No.	No. of teeth	Shape	Bore A _{H7}	Hub dia. B	Pitch dia. C	Outside dia. D	Allowable torque (N·m)		Allowable torque (kgf·m)		Backlash (mm)	Weight (kg)
							Bending strength	Surface durability	Bending strength	Surface durability		
SSG1-15	15	S1	6	12	15	17	2.96	1.03	0.30	0.11	0.08~0.16	0.016
SSG1-16	16			13	16	18	3.28	1.19	0.33	0.12		0.019
SSG1-17	17			14	17	19	3.60	1.36	0.37	0.14		0.022
SSG1-18	18			15	18	20	3.93	1.54	0.40	0.16		0.026
SSG1-19	19			16	19	21	4.26	1.73	0.43	0.18		0.030
SSG1-20	20			17	20	22	4.60	1.94	0.47	0.20		0.034
SSG1-21	21			18	21	23	4.94	2.14	0.50	0.22		0.035
SSG1-22	22			18	22	24	5.28	2.36	0.54	0.24		0.037
SSG1-23	23			20	23	25	5.63	2.59	0.57	0.26		0.044
SSG1-24	24			20	24	26	5.98	2.83	0.61	0.29		0.046
SSG1-25	25			20	25	27	6.33	3.07	0.65	0.31		0.048
SSG1-26	26			20	26	28	6.68	3.33	0.68	0.34		0.051
SSG1-27	27			20	27	29	7.04	3.60	0.72	0.37		0.054
SSG1-28	28			20	28	30	7.39	3.89	0.75	0.40		0.056
SSG1-29	29			25	29	31	7.75	4.18	0.79	0.43		0.073
SSG1-30	30			25	30	32	8.11	4.48	0.83	0.46		0.072
SSG1-32	32			25	32	34	7.37	4.27	0.75	0.43		0.078
SSG1-34	34			25	34	36	7.98	4.84	0.81	0.49		0.084
SSG1-35	35			25	35	37	8.28	5.14	0.84	0.52		0.088
SSG1-36	36	25	36	38	8.59	5.45	0.88	0.56	0.091			
SSG1-38	38	30	38	40	9.21	6.10	0.94	0.62	0.12			
SSG1-40	40	30	40	42	9.83	6.79	1.00	0.69	0.12			
SSG1-42	42	30	42	44	10.5	7.51	1.07	0.77	0.13			
SSG1-44	44	30	44	46	11.1	8.28	1.13	0.84	0.14			
SSG1-45	45	30	45	47	11.4	8.67	1.16	0.88	0.14			
SSG1-48	48	30	48	50	12.3	9.92	1.26	1.01	0.16			
SSG1-50	50	35	50	52	13.0	10.8	1.32	1.10	0.18			
SSG1-55	55	35	55	57	14.6	13.2	1.48	1.34	0.21			
SSG1-56	56	35	56	58	14.9	13.7	1.52	1.40	0.21			
SSG1-60	60	40	60	62	16.2	15.8	1.65	1.61	0.26			
SSG1-64	64	40	64	66	17.4	18.1	1.78	1.84	0.28			
SSG1-70	70	40	70	72	19.4	21.8	1.97	2.22	0.32			
SSG1-75	75	40	75	77	21.0	25.2	2.14	2.57	0.36			
SSG1-80	80	50	80	82	22.6	28.8	2.30	2.94	0.44			
SSG1-90	90	50	90	92	25.8	36.9	2.64	3.77	0.53			
SSG1-100	100	50	100	102	26.9	42.5	2.74	4.34	0.62			
SSG1-120	120	50	120	122	32.9	62.5	3.36	6.37	0.84			

[Caution on Product Characteristics] ① The allowable torques shown in the table are calculated values according to the assumed usage conditions. Please see Page 31 for more details. ② The backlash values shown in the table are the theoretical values for the backlash in the normal direction of a pair of identical gears in mesh.

[Caution on Secondary Operations] ① Please read "Caution on Performing Secondary Operations" (Page 32) when performing modifications and/or secondary operations for safety concerns. KHK Quick-Mod Gears, the KHK's system for quick modification of KHK stock gears is also available. ② Due to the gear teeth being induction hardened, no secondary operations can be performed on tooth areas including the bottom land (approx. 2 to 3 mm).

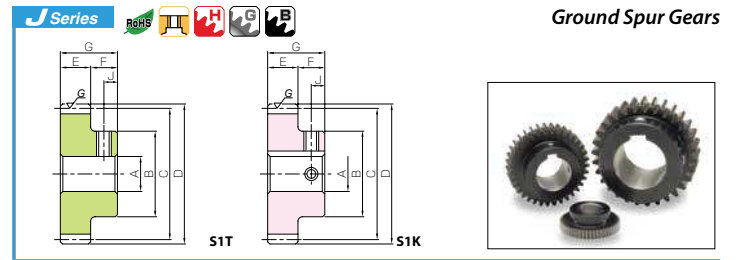

To order J Series products, please specify; Catalog No. + J + BORE

Bore H7	* The product shapes of J Series items are identified by background color.															
	6	8	10	12	14	15	16	17	18	19	20	22	25	28	30	
Keyway Js9	—		4 × 1.8			5 × 2.3			6 × 2.8			8 × 3.3				
Screw size	—		M4			M5			M4			M5			M6	
Catalog No.	M4	M5														
SSG1-15 J BORE																
SSG1-16 J BORE																
SSG1-17 J BORE																
SSG1-18 J BORE																
SSG1-19 J BORE																
SSG1-20 J BORE																
SSG1-21 J BORE																
SSG1-22 J BORE																
SSG1-23 J BORE																
SSG1-24 J BORE																
SSG1-25 J BORE																
SSG1-26 J BORE																
SSG1-27 J BORE																
SSG1-28 J BORE																
SSG1-29 J BORE																
SSG1-30 J BORE																
SSG1-32 J BORE																
SSG1-34 J BORE																
SSG1-35 J BORE																
SSG1-36 J BORE																
SSG1-38 J BORE																
SSG1-40 J BORE																
SSG1-42 J BORE																
SSG1-44 J BORE																
SSG1-45 J BORE																
SSG1-48 J BORE																
SSG1-50 J BORE																
SSG1-55 J BORE																
SSG1-56 J BORE																
SSG1-60 J BORE																
SSG1-64 J BORE																
SSG1-70 J BORE																
SSG1-75 J BORE																
SSG1-80 J BORE																
SSG1-90 J BORE																
SSG1-100 J BORE																
SSG1-120 J BORE																

[Caution on J series] ① As available-on-request products, requires a lead-time for shipping within 2 working-days (excludes the day ordered), after placing an order. Please allow additional shipping time to get to your local distributor. ② Number of products we can process for one order is 1 to 20 units. For quantities of 21 or more pieces, we need to quote price and lead time. ③ Keyways are made according to JIS B1301 standards, Js9 tolerance. ④ Certain products which would otherwise have a very long tapped hole are counterbored to reduce the length of the tap. ⑤ Areas of products which have been re-worked will not be black oxide coated. ⑥ For products having a tapped hole, a set screw is included. ⑦ The use of S1T shaped set screws for fastening gears to a shaft, is a method only applicable to light load usage. For secure fastening, please use dowel pins, in combination.



Specifications	
Precision grade	JIS grade N7 (JIS B1702-1: 1998) = JIS grade 3 (JIS B1702: 1976)
Gear teeth	Standard full depth
Pressure angle	20°
Material	S45C
Heat treatment	Tooth surface induction hardened
Tooth hardness	50 ~ 60HRC
Face width (E)	15
Hub width (F)	14
Total length (G)	29
Screw offset (J)	7

* The precision grade of J Series products is equivalent to the value shown in the table.

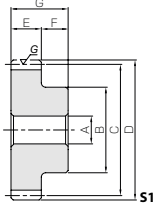

Catalog No.	No. of teeth	Shape	Bore A _{H7}	Hub dia. B	Pitch dia. C	Outside dia. D	Allowable torque (N·m)		Backlash (mm)	Weight (kg)	
							Bending strength	Surface durability			
SSG1.5-14	14	S1		10	17	21	24	11.1	3.73	1.13	0.38
SSG1.5-15	15				18	22.5	25.5	12.5	4.35	1.27	0.44
SSG1.5-16	16				20	24	27	13.8	5.02	1.41	0.51
SSG1.5-17	17				21	25.5	28.5	15.2	5.74	1.55	0.58
SSG1.5-18	18				22	27	30	16.6	6.51	1.69	0.66
SSG1.5-19	19				23	28.5	31.5	18.0	7.33	1.83	0.75
SSG1.5-20	20			24	30	33	19.4	8.20	1.98	0.84	
SSG1.5-21	21			25	31.5	34.5	20.8	9.12	2.12	0.93	
SSG1.5-22	22			26	33	36	18.6	8.41	1.89	0.86	
SSG1.5-23	23			27	34.5	37.5	19.8	9.27	2.02	0.95	
SSG1.5-24	24			12	28	36	39	21.0	10.2	2.14	1.04
SSG1.5-25	25				30	37.5	40.5	22.2	11.1	2.27	1.13
SSG1.5-26	26				32	39	42	23.5	12.1	2.39	1.23
SSG1.5-27	27				34	40.5	43.5	24.7	13.1	2.52	1.33
SSG1.5-28	28				36	42	45	26.0	14.1	2.65	1.44
SSG1.5-29	29				37	43.5	46.5	27.3	15.2	2.78	1.55
SSG1.5-30	30			15	38	45	48	28.5	16.3	2.91	1.66
SSG1.5-32	32				40	48	51	31.1	18.6	3.17	1.90
SSG1.5-34	34	42	51		54	33.6	21.1	3.43	2.15		
SSG1.5-35	35	42	52.5		55.5	34.9	22.4	3.56	2.29		
SSG1.5-36	36	45	54		57	36.2	23.8	3.70	2.43		
SSG1.5-38	38	45	57		60	38.8	26.6	3.96	2.71		
SSG1.5-40	40	50	60		63	41.5	29.6	4.23	3.02		
SSG1.5-42	42	50	63		66	44.1	32.8	4.50	3.35		
SSG1.5-44	44	50	66		69	46.7	36.2	4.77	3.69		
SSG1.5-45	45	18	50		67.5	70.5	48.1	37.9	4.90	3.86	
SSG1.5-48	48		50	72	75	52.0	43.4	5.31	4.42		
SSG1.5-50	50		60	75	78	54.7	47.2	5.58	4.82		
SSG1.5-55	55		60	82.5	85.5	61.4	57.7	6.26	5.88		
SSG1.5-56	56		60	84	87	62.8	59.9	6.40	6.11		
SSG1.5-60	60		60	90	93	68.1	69.2	6.95	7.06		
SSG1.5-64	64	20	60	96	99	67.9	73.2	6.92	7.46		
SSG1.5-70	70		60	105	108	75.4	88.4	7.69	9.01		
SSG1.5-75	75		60	112.5	115.5	81.7	102	8.33	10.4		
SSG1.5-80	80		70	120	123	88.0	117	8.97	12.0		
SSG1.5-90	90		70	135	138	101	150	10.3	15.3		
SSG1.5-100	100		70	150	153	113	187	11.6	19.1		

[Caution on Product Characteristics] ① The allowable torques shown in the table are calculated values according to the assumed usage conditions. Please see Page 31 for more details.
② The backlash values shown in the table are the theoretical values for the backlash in the normal direction of a pair of identical gears in mesh.

[Caution on Secondary Operations] ① Please read "Caution on Performing Secondary Operations" (Page 32) when performing modifications and/or secondary operations for safety concerns. KHK Quick-Mod Gears, the KHK's system for quick modification of KHK stock gears is also available.

② Due to the gear teeth being induction hardened, no secondary operations can be performed on tooth areas including the bottom land (approx. 2 to 3 mm).

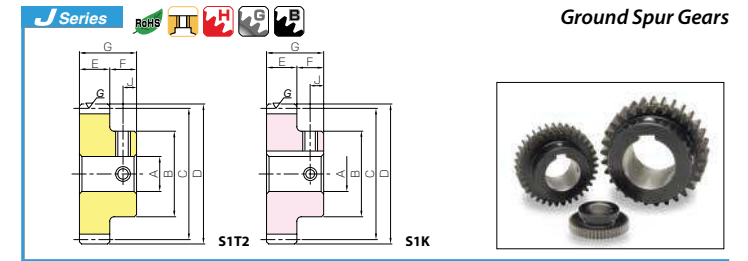

To order J Series products, please specify; Catalog No. + J + BORE

Bore H7	* The product shapes of J Series items are identified by background color.															
	10	12	14	15	16	17	18	19	20	22	25	28	30	32	35	40
Keyway Js9	10	12	14	15	16	17	18	19	20	22	25	28	30	32	35	40
Screw size	4 × 1.8	5 × 2.3				6 × 2.8				8 × 3.3			10 × 3.3		12 × 3.3	
Catalog No.	M4			M5			M6			M8						
SSG1.5-14 J BORE																
SSG1.5-15 J BORE																
SSG1.5-16 J BORE																
SSG1.5-17 J BORE																
SSG1.5-18 J BORE																
SSG1.5-19 J BORE																
SSG1.5-20 J BORE																
SSG1.5-21 J BORE																
SSG1.5-22 J BORE																
SSG1.5-23 J BORE																
SSG1.5-24 J BORE																
SSG1.5-25 J BORE																
SSG1.5-26 J BORE																
SSG1.5-27 J BORE																
SSG1.5-28 J BORE																
SSG1.5-29 J BORE																
SSG1.5-30 J BORE																
SSG1.5-32 J BORE																
SSG1.5-34 J BORE																
SSG1.5-35 J BORE																
SSG1.5-36 J BORE																
SSG1.5-38 J BORE																
SSG1.5-40 J BORE																
SSG1.5-42 J BORE																
SSG1.5-44 J BORE																
SSG1.5-45 J BORE																
SSG1.5-48 J BORE																
SSG1.5-50 J BORE																
SSG1.5-55 J BORE																
SSG1.5-56 J BORE																
SSG1.5-60 J BORE																
SSG1.5-64 J BORE																
SSG1.5-70 J BORE																
SSG1.5-75 J BORE																
SSG1.5-80 J BORE																
SSG1.5-90 J BORE																
SSG1.5-100 J BORE																

[Caution on J series] ① As available-on-request products, requires a lead-time for shipping within 2 working-days (excludes the day ordered), after placing an order. Please allow additional shipping time to get to your local distributor.
② Number of products we can process for one order is 1 to 20 units. For quantities of 21 or more pieces, we need to quote price and lead time.
③ Keyways are made according to JIS B1301 standards, Js9 tolerance.
④ Certain products which would otherwise have a very long tapped hole are contoured to reduce the length of the tap.
⑤ Areas of products which have been re-worked will not be black oxide coated.
⑥ For products having a tapped hole, a set screw is included.
⑦ The use of S1T2 shaped set screws for fastening gears to a shaft, is a method only applicable to light load usage. For secure fastening, please use dowel pins, in combination.



Specifications	
Precision grade	JIS grade N7 (JIS B1702-1: 1998) * JIS grade 3 (JIS B1702: 1976)
Gear teeth	Standard full depth
Pressure angle	20°
Material	S45C
Heat treatment	Tooth surface induction hardened
Tooth hardness	50 ~ 60HRC
Face width (E)	20
Hub width (F)	16
Total length (G)	36
Screw offset (J)	8

* The precision grade of J Series products is equivalent to the value shown in the table.

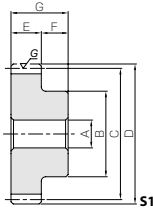

Catalog No.	No. of teeth	Shape	Bore A _{H7}	Hub dia. B	Pitch dia. C	Outside dia. D	Allowable torque (N·m)		Allowable torque (kgf·m)		Backlash (mm)	Weight (kg)		
							Bending strength	Surface durability	Bending strength	Surface durability				
SSG2-14	14	S1	12	22	28	32	26.3	9.01	2.69	0.92	0.10~0.20	0.11		
SSG2-15	15			24	30	34	29.6	10.5	3.01	1.07		0.14		
SSG2-16	16			26	32	36	27.3	10.1	2.78	1.03		0.16		
SSG2-17	17			28	34	38	30.0	11.6	3.06	1.18		0.19		
SSG2-18	18			30	36	40	32.7	13.1	3.34	1.34		0.22		
SSG2-19	19			31	38	42	35.5	14.8	3.62	1.51		0.24		
SSG2-20	20			32	40	44	38.3	16.6	3.91	1.69		0.25		
SSG2-21	21			34	42	46	41.1	18.4	4.20	1.88		0.28		
SSG2-22	22			36	44	48	44.0	20.4	4.49	2.08		0.32		
SSG2-23	23			37	46	50	46.9	22.5	4.78	2.30		0.35		
SSG2-24	24			15	15	38	48	52	49.8	24.7		5.08	2.52	0.38
SSG2-25	25					40	50	54	52.7	27.0		5.38	2.75	0.42
SSG2-26	26					42	52	56	55.7	29.3		5.68	2.99	0.46
SSG2-27	27					44	54	58	58.6	31.7		5.98	3.23	0.50
SSG2-28	28					45	56	60	61.6	34.2		6.28	3.49	0.54
SSG2-29	29					48	58	62	64.6	36.8		6.59	3.75	0.59
SSG2-30	30					50	60	64	67.6	39.5		6.89	4.03	0.62
SSG2-32	32					50	64	68	73.7	45.2		7.51	4.61	0.68
SSG2-34	34	50	68			72	79.8	51.3	8.13	5.23	0.74			
SSG2-35	35	50	70			74	82.8	54.5	8.45	5.56	0.78			
SSG2-36	36	50	72			76	85.9	57.8	8.76	5.90	0.81			
SSG2-38	38	50	76			80	92.1	64.8	9.39	6.60	0.89			
SSG2-40	40	60	80	84	98.3	72.1	10.0	7.35	1.06					
SSG2-42	42	60	84	88	105	79.9	10.7	8.15	1.14					
SSG2-44	44	60	88	92	111	88.1	11.3	8.98	1.22					
SSG2-45	45	20	20	60	90	94	92.3	11.6	9.41	1.27				
SSG2-48	48			60	96	100	114	97.6	11.6	9.95	1.40			
SSG2-50	50			60	100	104	120	106	12.2	10.8	1.45			
SSG2-55	55			60	110	114	134	130	13.7	13.3	1.71			
SSG2-56	56			60	112	116	137	135	14.0	13.8	1.76			
SSG2-60	60			65	120	124	149	156	15.2	15.9	2.05			
SSG2-64	64			65	128	132	161	179	16.4	18.3	2.30			
SSG2-70	70			70	140	144	179	216	18.2	22.0	2.76			
SSG2-75	75			70	150	154	194	249	19.7	25.4	3.12			
SSG2-80	80			80	160	164	194	265	19.8	27.0	3.65			
SSG2-90	90			80	180	184	222	338	22.6	34.5	4.49			
SSG2-100	100			80	200	204	250	421	25.4	43.0	5.42			
		25	25	65	120	124	149	156	15.2	15.9	2.05			
				65	128	132	161	179	16.4	18.3	2.30			
				70	140	144	179	216	18.2	22.0	2.76			
				70	150	154	194	249	19.7	25.4	3.12			
				80	160	164	194	265	19.8	27.0	3.65			
				80	180	184	222	338	22.6	34.5	4.49			
				80	200	204	250	421	25.4	43.0	5.42			

[Caution on Product Characteristics] ① The allowable torques shown in the table are calculated values according to the assumed usage conditions. Please see Page 31 for more details.
② The backlash values shown in the table are the theoretical values for the backlash in the normal direction of a pair of identical gears in mesh.

[Caution on Secondary Operations] ① Please read "Caution on Performing Secondary Operations" (Page 32) when performing modifications and/or secondary operations for safety concerns. KHK Quick-Mod Gears, the KHK's system for quick modification of KHK stock gears is also available.
② Due to the gear teeth being induction hardened, no secondary operations can be performed on tooth areas including the bottom land (approx. 2 to 3 mm).

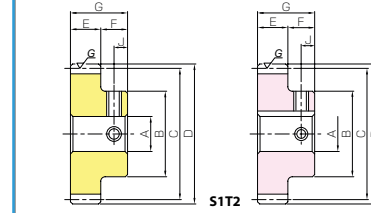

To order J Series products, please specify; Catalog No. + J + BORE

Bore H7	* The product shapes of J Series items are identified by background color.															
	12	14	15	16	17	18	19	20	22	25	28	30	32	35	40	45
Keyway Js9	4 x 1.8	5 x 2.3			6 x 2.8			8 x 3.3			10 x 3.3		12 x 3.3	14 x 3.8		
Screw size	M4			M5			M6			M8		M10				
Catalog No.	[Grid of product availability]															
SSG2-14 J BORE																
SSG2-15 J BORE																
SSG2-16 J BORE																
SSG2-17 J BORE																
SSG2-18 J BORE																
SSG2-19 J BORE																
SSG2-20 J BORE																
SSG2-21 J BORE																
SSG2-22 J BORE																
SSG2-23 J BORE																
SSG2-24 J BORE																
SSG2-25 J BORE																
SSG2-26 J BORE																
SSG2-27 J BORE																
SSG2-28 J BORE																
SSG2-29 J BORE																
SSG2-30 J BORE																
SSG2-32 J BORE																
SSG2-34 J BORE																
SSG2-35 J BORE																
SSG2-36 J BORE																
SSG2-38 J BORE																
SSG2-40 J BORE																
SSG2-42 J BORE																
SSG2-44 J BORE																
SSG2-45 J BORE																
SSG2-48 J BORE																
SSG2-50 J BORE																
SSG2-55 J BORE																
SSG2-56 J BORE																
SSG2-60 J BORE																
SSG2-64 J BORE																
SSG2-70 J BORE																
SSG2-75 J BORE																
SSG2-80 J BORE																
SSG2-90 J BORE																
SSG2-100 J BORE																

[Caution on J series] ① As available-on-request products, requires a lead-time for shipping within 2 working-days (excludes the day ordered), after placing an order. Please allow additional shipping time to get to your local distributor.
② Number of products we can process for one order is 1 to 20 units. For quantities of 21 or more pieces, we need to quote price and lead time.
③ Keyways are made according to JIS B1301 standards, Js9 tolerance.
④ Certain products which would otherwise have a very long tapped hole are contoured to reduce the length of the tap.
⑤ Areas of products which have been re-worked will not be black oxide coated.
⑥ For products having a tapped hole, a set screw is included.
⑦ The use of S1T2 shaped set screws for fastening gears to a shaft, is a method only applicable to light load usage. For secure fastening, please use dowel pins, in combination.



Specifications	
Precision grade	JIS grade N7 (JIS B1702-1: 1998) = JIS grade 3 (JIS B1702: 1976)
Gear teeth	Standard full depth
Pressure angle	20°
Material	S45C
Heat treatment	Tooth surface induction hardened
Tooth hardness	50 ~ 60HRC
Face width (E)	25
Hub width (F)	18
Total length (G)	43
Screw offset (J)	9

* The precision grade of J Series products is equivalent to the value shown in the table.

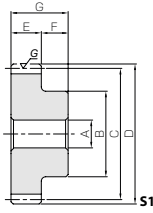

Catalog No.	No. of teeth	Shape	Bore A _{H7}	Hub dia. B	Pitch dia. C	Outside dia. D	Allowable torque (N·m)		Backlash (mm)	Weight (kg)																						
							Bending strength	Surface durability																								
SSG2.5-14	14	S1	15	28	35	40	42.9	14.9	4.37	1.52																						
SSG2.5-15	15										0.10~0.20																					
SSG2.5-16	16											0.46																				
SSG2.5-17	17												0.48																			
SSG2.5-18	18													0.53																		
SSG2.5-19	19														0.60																	
SSG2.5-20	20															0.66																
SSG2.5-21	21																0.72															
SSG2.5-22	22																	0.77														
SSG2.5-23	23																		0.87													
SSG2.5-24	24																			0.94												
SSG2.5-25	25																				1.05											
SSG2.5-26	26																					1.10										
SSG2.5-27	27																						1.23									
SSG2.5-28	28																							1.42								
SSG2.5-29	29																								1.55							
SSG2.5-30	30																									1.62						
SSG2.5-32	32																										1.69					
SSG2.5-34	34																											1.83				
SSG2.5-35	35																												1.92			
SSG2.5-36	36																													2.16		
SSG2.5-38	38																														2.32	
SSG2.5-40	40																															2.41
SSG2.5-42	42																															
SSG2.5-44	44	2.95																														
SSG2.5-45	45		3.46																													
SSG2.5-48	48			3.57																												
SSG2.5-50	50				4.01																											
SSG2.5-55	55					5.26																										
SSG2.5-56	56						6.15																									
SSG2.5-60	60							6.90																								
SSG2.5-70	70								17.4																							
SSG2.5-75	75									19.9																						
SSG2.5-80	80										21.7																					
												23.8																				
													26.8																			
														27.3																		
															29.7																	
																31.1																
																	33.1															
																		35.8														
																			40.7													
																				47.0												
																					53.7											

[Caution on Product Characteristics] ① The allowable torques shown in the table are calculated values according to the assumed usage conditions. Please see Page 31 for more details. ② The backlash values shown in the table are the theoretical values for the backlash in the normal direction of a pair of identical gears in mesh.

[Caution on Secondary Operations] ① Please read "Caution on Performing Secondary Operations" (Page 32) when performing modifications and/or secondary operations for safety concerns. KHK Quick-Mod Gears, the KHK's system for quick modification of KHK stock gears is also available. ② Due to the gear teeth being induction hardened, no secondary operations can be performed on tooth areas including the bottom land (approx. 2 to 3 mm).

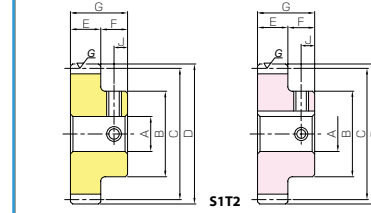

To order J Series products, please specify; Catalog No. + J + BORE

Bore H7	* The product shapes of J Series items are identified by background color.															
	15	16	17	18	19	20	22	25	28	30	32	35	40	45	50	
Keyway Js9	5 x 2.3			6 x 2.8			8 x 3.3			10 x 3.3			12 x 3.3		14 x 3.8	
Screw size	M4			M5			M6			M8			M10			
Catalog No.																
SSG2.5-14 J BORE																
SSG2.5-15 J BORE																
SSG2.5-16 J BORE																
SSG2.5-17 J BORE																
SSG2.5-18 J BORE																
SSG2.5-19 J BORE																
SSG2.5-20 J BORE																
SSG2.5-21 J BORE																
SSG2.5-22 J BORE																
SSG2.5-23 J BORE																
SSG2.5-24 J BORE																
SSG2.5-25 J BORE																
SSG2.5-26 J BORE																
SSG2.5-27 J BORE																
SSG2.5-28 J BORE																
SSG2.5-29 J BORE																
SSG2.5-30 J BORE																
SSG2.5-32 J BORE																
SSG2.5-34 J BORE																
SSG2.5-35 J BORE																
SSG2.5-36 J BORE																
SSG2.5-38 J BORE																
SSG2.5-40 J BORE																
SSG2.5-42 J BORE																
SSG2.5-44 J BORE																
SSG2.5-45 J BORE																
SSG2.5-48 J BORE																
SSG2.5-50 J BORE																
SSG2.5-55 J BORE																
SSG2.5-56 J BORE																
SSG2.5-60 J BORE																
SSG2.5-70 J BORE																
SSG2.5-75 J BORE																
SSG2.5-80 J BORE																

[Caution on J series] ① As available-on-request products, requires a lead-time for shipping within 2 working-days (excludes the day ordered), after placing an order. Please allow additional shipping time to get to your local distributor. ② Number of products we can process for one order is 1 to 20 units. For quantities of 21 or more pieces, we need to quote price and lead time. ③ Keyways are made according to JIS B1301 standards, Js9 tolerance. ④ Certain products which would otherwise have a very long tapped hole are counterbored to reduce the length of the tap. ⑤ Areas of products which have been re-worked will not be black oxide coated. ⑥ For products having a tapped hole, a set screw is included. ⑦ The use of S1T2 shaped set screws for fastening gears to a shaft, is a method only applicable to light load usage. For secure fastening, please use dowel pins, in combination.



Specifications	
Precision grade	JIS grade N7 (JIS B1702-1: 1998) = JIS grade 3 (JIS B1702: 1976)
Gear teeth	Standard full depth
Pressure angle	20°
Material	S45C
Heat treatment	Tooth surface induction hardened
Tooth hardness	50 ~ 60HRC
Face width (E)	30
Hub width (F)	20
Total length (G)	50
Screw offset (J)	10

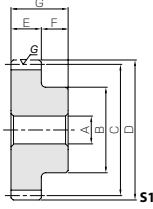

* The precision grade of J Series products is equivalent to the value shown in the table.

Catalog No.	No. of teeth	Shape	Bore A _{H7}	Hub dia. B	Pitch dia. C	Outside dia. D	Allowable torque (N·m)		Backlash (mm)	Weight (kg)			
							Bending strength	Surface durability					
SSG3-14	14	S1	16	34	42	48	74.1	26.1	7.55	2.66	0.10~0.20	0.39	
SSG3-15	15				45	51	83.1	30.5	8.48	3.11			
SSG3-16	16				38	48	54	92.1	35.2	9.39			3.59
SSG3-17	17				37	51	57	101	40.3	10.3			4.11
SSG3-18	18				40	54	60	110	45.8	11.3			4.67
SSG3-19	19				45	57	63	120	51.6	12.2			5.26
SSG3-20	20			50	60	66	129	57.8	13.2	5.90	0.12~0.22	1.25	
SSG3-21	21			52	63	69	139	64.4	14.2	6.57			
SSG3-22	22			54	66	72	149	71.3	15.1	7.28			
SSG3-23	23			56	69	75	158	78.7	16.1	8.02			
SSG3-24	24			58	72	78	168	86.4	17.1	8.81			
SSG3-25	25			60	75	81	178	94.5	18.1	9.64			
SSG3-26	26			62	78	84	188	103	19.2	10.5	0.14~0.24	1.48	
SSG3-27	27			65	81	87	198	111	20.2	11.3			
SSG3-28	28			70	84	90	208	120	21.2	12.2			
SSG3-29	29			70	87	93	218	129	22.2	13.2			
SSG3-30	30			75	90	96	228	138	23.3	14.1			
SSG3-32	32			75	96	102	229	146	23.4	14.9			
SSG3-34	34	75	102	108	248	166	25.3	17.0	0.10~0.20	2.43			
SSG3-35	35	80	105	111	258	177	26.3	18.0					
SSG3-36	36	80	108	114	268	188	27.3	19.1					
SSG3-38	38	80	114	120	287	210	29.2	21.4					
SSG3-40	40	80	120	126	306	234	31.2	23.9					
SSG3-42	42	80	126	132	326	260	33.2	26.5					
SSG3-44	44	80	132	138	345	286	35.2	29.2	0.14~0.24	3.82			
SSG3-45	45	80	135	141	355	300	36.2	30.6					
SSG3-48	48	85	144	150	384	343	39.2	35.0					
SSG3-50	50	85	150	156	404	374	41.2	38.1					
SSG3-55	55	90	165	171	421	423	42.9	43.2					
SSG3-56	56	90	168	174	430	439	43.9	44.8					
SSG3-60	60	30	100	180	186	467	508	47.6	51.8	0.10~0.20	6.95		
SSG3-70	70		100	210	216	560	699	57.1	71.3				
SSG3-75	75		100	225	231	607	806	61.9	82.2				
SSG3-80	80		100	240	246	654	921	66.7	93.9				

- [Caution on Product Characteristics]**
- The allowable torques shown in the table are calculated values according to the assumed usage conditions. Please see Page 31 for more details.
 - The backlash values shown in the table are the theoretical values for the backlash in the normal direction of a pair of identical gears in mesh.

- [Caution on Secondary Operations]**
- Please read "Caution on Performing Secondary Operations" (Page 32) when performing modifications and/or secondary operations for safety concerns. KHK Quick-Mod Gears, the KHK's system for quick modification of KHK stock gears is also available.
 - Due to the gear teeth being induction hardened, no secondary operations can be performed on tooth areas including the bottom land (approx. 2 to 3 mm).

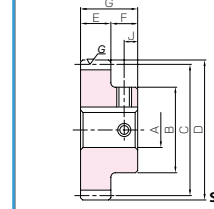

To order J Series products, please specify: **Catalog No. + J + BORE**

Bore H7	* The product shapes of J Series items are identified by background color.													
	16	17	18	19	20	22	25	28	30	32	35	40	45	50
Keyway Js9	16	17	18	19	20	22	25	28	30	32	35	40	45	50
Screw size	5 x 2.3	6 x 2.8				8 x 3.3			10 x 3.3		12 x 3.3		14 x 3.8	
Catalog No.	M4	M5				M6			M8		M10			
SSG3-14 J BORE														
SSG3-15 J BORE														
SSG3-16 J BORE														
SSG3-17 J BORE														
SSG3-18 J BORE														
SSG3-19 J BORE														
SSG3-20 J BORE														
SSG3-21 J BORE														
SSG3-22 J BORE														
SSG3-23 J BORE														
SSG3-24 J BORE														
SSG3-25 J BORE														
SSG3-26 J BORE														
SSG3-27 J BORE														
SSG3-28 J BORE														
SSG3-29 J BORE														
SSG3-30 J BORE														
SSG3-32 J BORE														
SSG3-34 J BORE														
SSG3-35 J BORE														
SSG3-36 J BORE														
SSG3-38 J BORE														
SSG3-40 J BORE														
SSG3-42 J BORE														
SSG3-44 J BORE														
SSG3-45 J BORE														
SSG3-48 J BORE														
SSG3-50 J BORE														
SSG3-55 J BORE														
SSG3-56 J BORE														
SSG3-60 J BORE														
SSG3-70 J BORE														
SSG3-75 J BORE														
SSG3-80 J BORE														

- [Caution on J series]**
- As available-on-request products, requires a lead-time for shipping within 2 working-days (excludes the day ordered), after placing an order. Please allow additional shipping time to get to your local distributor.
 - Number of products we can process for one order is 1 to 20 units. For quantities of 21 or more pieces, we need to quote price and lead time.
 - Keyways are made according to JIS B1301 standards, Js9 tolerance.
 - Certain products which would otherwise have a very long tapped hole are counterbored to reduce the length of the tap.
 - Areas of products which have been re-worked will not be black oxide coated.
 - For products having a tapped hole, a set screw is included.



Specifications	
Precision grade	JIS grade N7 (JIS B1702-1: 1998) JIS grade 3 (JIS B1702: 1978)
Gear teeth	Standard full depth
Pressure angle	20°
Material	S45C
Heat treatment	Tooth surface induction hardened
Tooth hardness	50 ~ 60HRC

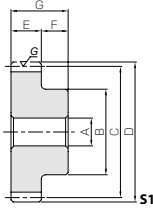

Catalog No.	Module	No. of teeth	Shape	Bore		Pitch dia.	Outside dia.	Face width	Hub width		Total length
				A _{H7}	B				C	D	
SSG4-14	m4	14	S1	20	40	56	64	40	25	65	
SSG4-15		15	S1	20	45	60	68	40	25	65	
SSG4-16		16	S1	20	50	64	72	40	25	65	
SSG4-18		18	S1	20	60	72	80	40	25	65	
SSG4-20		20	S1	20	65	80	88	40	25	65	
SSG4-22		22	S1	20	70	88	96	40	25	65	
SSG4-24		24	S1	20	75	96	104	40	25	65	
SSG4-25		25	S1	20	80	100	108	40	25	65	
SSG4-28		28	S1	20	85	112	120	40	25	65	
SSG4-30		30	S1	20	90	120	128	40	25	65	
SSG4-32		32	S1	25	90	128	136	40	25	65	
SSG4-35		35	S1	25	90	140	148	40	25	65	
SSG4-36		36	S1	25	90	144	152	40	25	65	
SSG4-40		40	S1	25	90	160	168	40	25	65	
SSG4-42		42	S1	25	90	168	176	40	25	65	
SSG4-44		44	S1	30	90	176	184	40	25	65	
SSG4-45		45	S1	30	90	180	188	40	25	65	
SSG4-48		48	S1	30	100	192	200	40	25	65	
SSG4-50		50	S1	30	100	200	208	40	25	65	
SSG4-55		55	S1	30	100	220	228	40	25	65	
SSG4-56	56	S1	30	110	224	232	40	25	65		
SSG4-60	60	S1	30	110	240	248	40	25	65		
SSG5-20	m5	20	S1	25	82	100	110	50	25	75	
SSG5-25		25	S1	25	105	125	135	50	25	75	
SSG5-30		30	S1	25	120	150	160	50	25	75	
SSG6-20	m6	20	S1	25	100	120	132	60	28	88	
SSG6-25		25	S1	30	125	150	162	60	28	88	
SSG6-30		30	S1	30	150	180	192	60	28	88	

[Caution on Product Characteristics] ① The allowable torques shown in the table are calculated values according to the assumed usage conditions. Please see Page 31 for more details.
② The backlash values shown in the table are the theoretical values for the backlash in the normal direction of a pair of identical gears in mesh.

* For products not categorized in our KHK Stock Gear series, custom gear production services with **short lead times** is available. For details see Page 8.

Allowable torque (N·m)		Allowable torque (kgf·m)		Backlash (mm)	Weight (kg)	Catalog No.
Bending strength	Surface durability	Bending strength	Surface durability			
176	63.4	17.9	6.47	0.14~0.24	0.86	SSG4-14
197	74.1	20.1	7.55	0.14~0.24	1.04	SSG4-15
218	85.6	22.3	8.73	0.14~0.24	1.24	SSG4-16
262	111	26.7	11.4	0.14~0.24	1.67	SSG4-18
307	141	31.3	14.3	0.14~0.24	2.07	SSG4-20
352	174	35.9	17.7	0.14~0.24	2.50	SSG4-22
368	194	37.5	19.8	0.14~0.24	2.98	SSG4-24
389	213	39.7	21.7	0.14~0.24	3.29	SSG4-25
455	270	46.4	27.5	0.16~0.26	4.05	SSG4-28
499	313	50.9	31.9	0.16~0.26	4.64	SSG4-30
544	358	55.5	36.5	0.16~0.26	5.04	SSG4-32
612	432	62.4	44.0	0.16~0.26	5.83	SSG4-35
634	458	64.7	46.7	0.16~0.26	6.11	SSG4-36
674	529	68.7	54.0	0.16~0.26	7.31	SSG4-40
717	586	73.1	59.7	0.16~0.26	7.96	SSG4-42
760	646	77.5	65.8	0.16~0.26	8.53	SSG4-44
781	677	79.6	69.0	0.16~0.26	8.88	SSG4-45
846	774	86.3	79.0	0.16~0.26	10.3	SSG4-48
889	842	90.7	85.9	0.16~0.26	11.0	SSG4-50
998	1030	102	105	0.16~0.26	13.1	SSG4-55
1020	1060	104	109	0.16~0.26	13.9	SSG4-56
1110	1230	113	125	0.16~0.26	15.7	SSG4-60
553	259	56.4	26.5	0.14~0.26	3.83	SSG5-20
760	426	77.5	43.4	0.18~0.30	6.23	SSG5-25
975	623	99.4	63.5	0.18~0.30	8.87	SSG5-30
955	457	97.4	46.6	0.18~0.30	6.71	SSG6-20
1310	747	134	76.2	0.18~0.30	10.5	SSG6-25
1560	1020	160	104	0.18~0.30	15.4	SSG6-30

[Caution on Secondary Operations] ① Please read "Caution on Performing Secondary Operations" (Page 32) when performing modifications and/or secondary operations for safety concerns. KHK Quick-Mod Gears, the KHK's system for quick modification of KHK stock gears is also available.
② Due to the gear teeth being induction hardened, no secondary operations can be performed on tooth areas including the bottom land (approx. 2 to 3 mm).

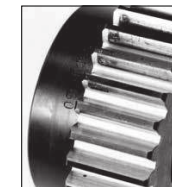

■ Poor tooth contact occurred on SSG3-30 (Approx. 30% of the proper gear contact)

Gear Oil (Equivalent to JIS gear oil category 2 and No. 3)

The design conditions are load torque at 278 rpm, of 417N·m (12 kW), 1.5 times the allowable bending strength, and 3 times the allowable surface durability torque. The pitting occurs on the poor tooth contact area after only 60 hours of continuous operation.