

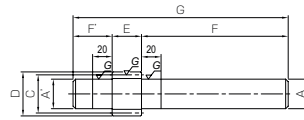

Specifications	
Precision grade	JIS grade N7 (JIS B1702-1: 1998) JIS grade 3 (JIS B1702: 1976)
Gear teeth	Standard full depth
Pressure angle	20°
Material	S45C
Heat treatment	Thermal refined, tooth surface induction hardened
Tooth hardness	50 ~ 60HRC



57

Catalog No.	Pitch mm (Module)	No. of teeth	Profile shift coefficient	Shape	Shaft dia. (L)		Pitch dia. C	Outside dia. D	Face width E	Shaft dia. (R)	
					A'	F'				A	F
SSCPGS5-15	CP5 (1.5915)	15	0	S7	19.2	25	23.87	27.06	15	19.2	100
SSCPGS5-20		20	0		27.2	31.83	35.01	27.2			
SSCPGS5-25		25	0		30.2	39.79	42.97	30.2			
SSCPGS10-10	CP10 (3.1831)	10	+0.5	S7	25.2	40	31.83	41.05	30	25.2	150
SSCPGS10-15		15	0		35.2	47.75	54.11	35.2			
SSCPGS10-20		20	0		40.2	63.66	70.03	40.2			

[Caution on Product Characteristics] ① The allowable torques shown in the table are the calculated values according to the assumed usage conditions. Please see Page 227 for more details.
② The backlash values shown in the table are the theoretical values when these gears and SRGCP Racks are in mesh.
③ To find the center distance of profile shifted spur gears, please see the appropriate section on page 46 - 47.

Total length G	Distance traveled in one turn (mm)	Allowable torque (N·m)		Allowable torque (kgf·m)		Backlash (mm)	Weight (kg)	Catalog No.
		Bending strength	Surface durability	Bending strength	Surface durability			
140	75	21.2	8.49	2.16	0.87	0.04~0.18	0.34	SSCPGS5-15
	100	32.0	16.6	3.26	1.70	0.04~0.18	0.66	SSCPGS5-20
	125	43.2	27.8	4.40	2.83	0.04~0.18	0.85	SSCPGS5-25
220	100	121	25.9	12.4	2.64	0.05~0.20	0.97	SSCPGS10-10
	150	169	67.9	17.3	6.93	0.05~0.20	1.87	SSCPGS10-15
	200	256	133	26.1	13.6	0.06~0.21	2.64	SSCPGS10-20

[Caution on Secondary Operations] ① Please read "Caution on Performing Secondary Operations" (Page 228) when performing modifications and/or secondary operations for safety concerns. KHK Quick-Mod Gears, the KHK's system for quick modification of KHK stock gears is also available.
② Due to the gear teeth being induction hardened, no secondary operations can be performed on tooth areas including the bottom land (approx. 2 to 3 mm). Use carbide tools for the modification of the shaft area near the bottom land.



Specifications	
Precision grade	JIS grade N7 (JIS B1702-1: 1998) * JIS grade 3 (JIS B1702: 1976)
Gear teeth	Standard full depth
Pressure angle	20°
Material	S45C
Heat treatment	Tooth surface induction hardened
Tooth hardness	50 ~ 60HRC
Pitch	CP5 CP10 CP15 CP20
Face width (E)	15 30 50 60
Hub width (F)	15 20 27 30
Total length (G)	30 50 77 90
Screw offset (J)	7.5 10 13.5 15

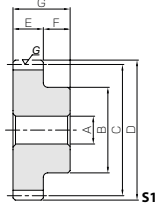

51

* The precision grade of J Series products is equivalent to the value shown in the table.

Catalog No.	Pitch mm (Module)	No. of teeth	Shape	Bore		Pitch dia. C	Outside dia. D	Distance traveled in one turn (mm)	Allowable torque (N·m)		Allowable torque (kgf·m)		Backlash (mm)	Weight (kg)
				A _{H7}	B				Bending strength	Surface durability	Bending strength	Surface durability		
SSCPG5-25	CP5 (1.5915)	20	S1	8	25	31.83	35.01	100	24.8	13.7	2.53	1.40	0.04~0.18	0.14
		25		10	32	39.79	42.97	125	33.5	23.0	3.41	2.34		0.22
		30		10	38	47.75	50.93	150	42.3	35.0	4.32	3.57		0.33
		40		12	50	63.66	66.85	200	60.4	66.9	6.16	6.82		0.58
SSCPG10-20	CP10 (3.1831)	20	S1	15	50	63.66	70.03	200	198	110	20.2	11.2	0.06~0.21	0.99
		25		20	60	79.58	85.94	250	268	184	27.3	18.7		1.49
		30		20	75	95.49	101.86	300	339	280	34.5	28.5		2.26
		40		25	80	127.32	133.69	400	483	535	49.3	54.6		3.59
SSCPG15-20	CP15 (4.7746)	25	S1	25	75	95.49	105.04	300	744	399	75.9	40.7	0.07~0.23	3.45
		30		25	100	119.37	128.92	375	1005	667	102	68.0		5.76
		40		25	110	143.24	152.79	450	1270	1020	130	104		8.04
SSCPG20-25	CP20 (6.3662)	20	S1	25	100	127.32	140.06	400	1590	880	162	89.7	0.09~0.25	7.50
		25		30	130	159.15	171.89	500	2140	1470	219	150		12.0
		30		30	150	190.99	203.72	600	2710	2240	276	228		17.2

[Caution on Product Characteristics] ① The allowable torques shown in the table are the calculated values according to the assumed usage conditions. Please see Page 227 for more details.
② The backlash values shown in the table are the theoretical values when these gears and SRGCP Racks are in mesh.

[Caution on Secondary Operations] ① Please read "Caution on Performing Secondary Operations" (Page 228) when performing modifications and/or secondary operations for safety concerns. KHK Quick-Mod Gears, the KHK's system for quick modification of KHK stock gears is also available.
② Due to the gear teeth being induction hardened, no secondary operations can be performed on tooth areas including the bottom land (approx. 2 to 3 mm).

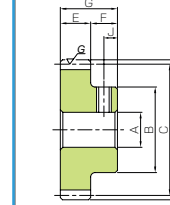

S1T

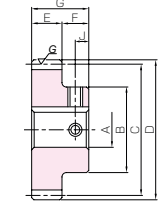

S1K



To order J Series products, please specify; Catalog No. + J + BORE

Bore H7		* The product shapes of J Series items are identified by background color.																		
Keyway J _{s9}	8	10	12	14	15	16	17	18	19	20	22	25	28	30	32	35	40	45	50	
Screw size	—	4 × 1.8			5 × 2.3				6 × 2.8			8 × 3.3			10 × 3.3		12 × 3.3		14 × 3.8	
Catalog No.	M5	M4				M5				M6			M8		M10					
SSCPG5-20 J BORE																				
SSCPG5-25 J BORE																				
SSCPG5-30 J BORE																				
SSCPG5-40 J BORE																				
SSCPG10-20 J BORE																				
SSCPG10-25 J BORE																				
SSCPG10-30 J BORE																				
SSCPG10-40 J BORE																				

[Caution on J series] ① As available-on-request products, requires a lead-time for shipping within 2 working-days (excludes the day ordered), after placing an order. Please allow additional shipping time to get to your local distributor.
② Number of products we can process for one order is 1 to 20 units. For quantities of 21 or more pieces, we need to quote price and lead time.
③ Keyways are made according to JIS B1301 standards, Js9 tolerance.
④ Certain products which would otherwise have a very long tapped hole are counterbored to reduce the length of the tap. (Products marked with "*" are tap sizes).
⑤ Areas of products which have been re-worked will not be black oxide coated.
⑥ For products having a tapped hole, a set screw is included.
⑦ The use of S1T shaped set screws for fastening gears to a shaft, is a method only applicable to light load usage. For secure fastening, please use dowel pins, in combination.