



SRO · SROS Steel Round Racks



Module 1 ~ 6

Round Racks



Specifications	
Precision grade	KHK R 001 grade 4
Gear teeth	Standard full depth
Pressure angle	20°
Material	S45C
Heat treatment	—
Tooth hardness	(less than 95HRB)

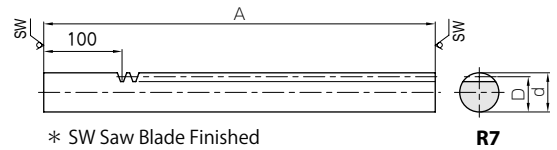
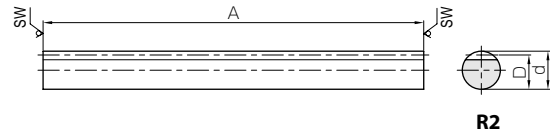

* SW Saw Blade Finished

Catalog No.	Module	Effective no. of teeth	Shape	Total length			Allowable force (N)		Allowable force (kgf)		Weight (kg)
				A	Outside dia. d_{h9}	Height to pitch line D	Bending strength	Surface durability	Bending strength	Surface durability	
SRO1-500	m1	159	R2	505	10	9	800	121	81.6	12.3	0.29
SRO1.5-500	m1.5	105	R2	505	15	13.5	1800	288	184	29.3	0.65
SRO2-500 SRO2-1000	m2	79 159	R2	505 1010	20	18	3200	530	326	54.0	1.16 2.31
SRO2.5-500 SRO2.5-1000	m2.5	63 127	R2	505 1010	25	22.5	5000	848	510	86.5	1.81 3.61
SRO3-500 SRO3-1000	m3	52 105	R2	505 1010	30	27	7200	1240	735	127	2.60 5.20
SRO4-500 SRO4-1000	m4	39 79	R2	505 1010	40	36	12800	2270	1310	232	4.62 9.24
SRO5-1000	m5	63	R2	1010	50	45	20000	3620	2040	369	14.4
SRO6-1000	m6	52	R2	1010	60	54	28800	5290	2940	539	20.8

Catalog No.	Module	Effective no. of teeth	Shape	Total length			Allowable force (N)		Allowable force (kgf)		Weight (kg)
				A	Outside dia. d_{h9}	Height to pitch line D	Bending strength	Surface durability	Bending strength	Surface durability	
SROS1-500	m1	128	R7	505	10	9	800	121	81.6	12.3	0.29
SROS1.5-500	m1.5	85	R7	505	15	13.5	1800	288	184	29.3	0.66
SROS2-500	m2	64	R7	505	20	18	3200	530	326	54.0	1.17
SROS2.5-500	m2.5	51	R7	505	25	22.5	5000	848	510	86.5	1.83
SROS3-500	m3	42	R7	505	30	27	7200	1240	735	127	2.64

[Caution on Product Characteristics]

- The allowable forces shown in the table are the calculated values according to the assumed usage conditions. Please see Page 189 for more details.
- The backlash of racks differ depending on the size of the mating pinion. Please calculate the backlash from the backlash value of the mating pinion. Also, please refer to the data in the section called 'Backlash of Rack Tooth (Amount of Tooth Thinning)' on Page 191.
- Tolerance of "d" dimension of SRO6-1000 is h10.

[Caution on Secondary Operations]

- Please read "Caution on Performing Secondary Operations" (Page 192) when performing modifications and/or secondary operations for safety concerns. KHK Quick-Mod Gears, the KHK's system for quick modification of KHK stock gears is also available.
- Please avoid hardening of Round Racks. It causes contortion and deformation, and straightening processes can hardly be applied.



SURO Stainless Steel Round Racks



Module 1 ~ 3

Stainless Steel Round Racks



Specifications	
Precision grade	KHK R 001 grade 5
Gear teeth	Standard full depth
Pressure angle	20°
Material	SUS303
Heat treatment	—
Tooth hardness	(less than 187HB)

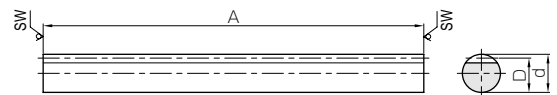

* SW Saw Blade Finished

R2

Catalog No.	Module	Effective no. of teeth	Shape	Total length			Allowable force (N)		Allowable force (kgf)		Weight (kg)
				A	Outside dia. d_{h9}	Height to pitch line D	Bending strength	Surface durability	Bending strength	Surface durability	
SURO1-500	m1	159	R2	505	10	9	382	67.9	39.0	6.93	0.29
SURO1.5-500	m1.5	105	R2	505	15	13.5	859	162	87.6	16.5	0.65
SURO2-500 SURO2-1000	m2	79 159	R2	505 1010	20	18	1530	298	156	30.4	1.15 2.30
SURO2.5-500 SURO2.5-1000	m2.5	63 127	R2	505 1010	25	22.5	2390	477	243	48.7	1.79 3.59
SURO3-500 SURO3-1000	m3	52 105	R2	505 1010	30	27	3440	700	351	71.4	2.58 5.17

[Caution on Product Characteristics]

- The allowable forces shown in the table are the calculated values according to the assumed usage conditions. Please see Page 189 for more details.
- The backlash of racks differ depending on the size of the mating pinion. Please calculate the backlash from the backlash value of the mating pinion. Also, please refer to the data in the section called 'Backlash of Rack Tooth (Amount of Tooth Thinning)' on Page 191.

[Caution on Secondary Operations]

- Please read "Caution on Performing Secondary Operations" (Page 192) when performing modifications and/or secondary operations for safety concerns. KHK Quick-Mod Gears, the KHK's system for quick modification of KHK stock gears is also available.

Spur Gears

Helical Gears

Internal Gears

Racks

CP Racks & Pinions

Miter Gears

Bevel Gears

Screw Gears

Worm Gear Pair

Bevel Gearboxes

Other Products