

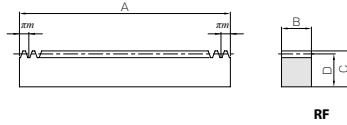

New! Square Racks are now available at low prices!

Specifications	
Precision grade	KHK R 001 grade 4
Gear teeth	Standard full depth
Pressure angle	20°
Material	S45C
Heat treatment	—
Tooth hardness	(less than 95HRB)



* Reasonably priced and have similar precision grade as SRF, allowing compact design.

Catalog No.	Module	No. of teeth	Shape	Total length				Allowable force (N)		Allowable force (kgf)		Weight (kg)
				A	B	C	D	Bending strength	Surface durability	Bending strength	Surface durability	
SRAF1.5-1000	m1.5	212	RF	999.03	15	15	13.5	2160	421	220	42.9	1.59
SRAF2-1000	m2	160		1005.31	20	20	18	3830	775	391	79.0	2.84
SRAF2.5-1000	m2.5	128		1005.31	25	25	22.5	5990	1240	611	127	4.44
SRAF3-1000	m3	106		999.03	30	30	27	8620	1820	879	186	6.35
SRAF4-1000	m4	80		1005.31	40	40	36	15300	3330	1560	339	11.4
SRAF1.5-2000	m1.5	435		2049.88	17	17	15.5	2443	421	249	43	4.24
SRAF2-2000	m2	326		2048.31	20	20	18	3833	775	391	79	5.79
SRAF2.5-2000	m2.5	261		2049.88	25	25	22.5	5989	1241	611	127	9.05
SRAF3-2000	m3	217		2045.17	30	30	27	8624	1821	879	186	13.0

Catalog No.	Module	No. of teeth	Shape	Total length				Mounting hole dimensions			No. of mounting holes	Mounting screw size
				A	B	C	D	E	F	G		
● SRAFK1.5-1000J	m1.5	212	RA	999.03	15	15	13.5	5	49.51	180	6	M5
● SRAFD2-1000J	m2	160	RD	1005.31	20	20	18	7	52.65			M6
● SRAFD2.5-1000J	m2.5	128	RD	1005.31	25	25	22.5	9	52.65			M8
● SRAFD3-1000J	m3	106	RD	999.03	30	30	27	11	49.51			M10
● SRAFD4-1000J	m4	80	RD	1005.31	40	40	36	15	52.65			M12

- [Caution on Product Characteristics]
- The allowable forces shown in the table are the calculated values according to the assumed usage conditions. Please see Page 189 for more details.
 - The backlash of racks differ depending on the size of the mating pinion. Please calculate the backlash from the backlash value of the mating pinion. Also, please refer to the data in the section called 'Backlash of Rack Tooth (Amount of Tooth Thinning)' on Page 191.

- [Caution on Secondary Operations]
- Please read "Caution on Performing Secondary Operations" (Page 192) when performing modifications and/or secondary operations for safety concerns. KHK Quick-Mod Gears, the KHK's system for quick modification of KHK stock gears is also available.
 - If gear tooth hardening, or thermal refining, is applied, the decarburization layer (approx. 0.5 mm thickness) on the rectangular surfaces cannot have the hardness you designate.

* For products not categorized in our KHK Stock Gear series, custom gear production services with **short lead times** is available. For details see Page 8.

New

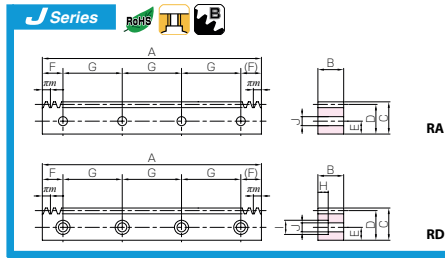

Counterbore dimensions			Allowable force (N)		Allowable force (kgf)		Weight (kg)	Catalog No.
H	I	J	Bending strength	Surface durability	Bending strength	Surface durability		
—	—	6	2160	421	220	42.9	1.57	● SRAFK1.5-1000J
7	11	7	3830	775	391	79.0	2.79	● SRAFD2-1000J
8.6	14	9	5990	1240	611	127	4.33	● SRAFD2.5-1000J
10.8	17.5	11	8620	1820	879	186	6.14	● SRAFD3-1000J
13	20	14	15300	3330	1560	339	11.0	● SRAFD4-1000J

- [Caution on J series]
- As available-on-request products, requires a lead-time for shipping within **2 working-days (excludes the day ordered)**, after placing an order. Please allow additional shipping time to get to your local distributor.
 - Number of products we can process for one order is **1 to 20 units**. For quantities of 21 or more pieces, we need to quote price and lead time.
 - No black oxide is re-applied after adding secondary operation of mounting holes.

GCU-R Rack Kit

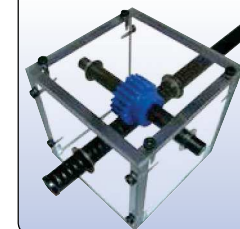

Installation : Parallel axes gears
Gear Type : Racks & Pinions
Gears : SRO1.5-500
PS1.5-20
Weight : Approx. 1kg

Use of racks enables the conversion of rotation motion to linear motion. Applications include devices that provide lift.